



Jungle Tower

Installation Instructions

PZU918J

PZU918J

Jungle Tower Installation Instructions

design
make
play
SutcliffePlay

- 1 Check using the Parts List that none of the components are missing.
- 2 Plan the final position of the play equipment ensuring there is sufficient space.
- 3 The stainless steel slides should face north or be shaded to prevent over heating. Slide run- outs should be inclined downwards by approximately 2 degrees for drainage purposes.
- 4 Excavate the foundation holes in accordance with the plan.
- 5 Sort and identify parts before assembly. Each leg is numbered to correspond with the foundation plan.
- 6 Position 2 off 300 long spragging irons into the holes provided in each post upright and stand in the foundation holes. Assemble the decks at the positions marked on the posts. Do not tighten the fixing bolts until all the activities have been assembled.
- 7 Assemble the activities onto the posts. Leave fixing bolts loose until all the activities have been assembled.
- 8 Fill the foundation holes to the required depth with concrete.
- 9 Do not allow the equipment to be used until the concrete has set (2 - 3 days) and the required safety surfacing has been installed.
- 10 Tighten all fixing bolts.
- 11 Follow the maintenance instructions supplied.

During installation care must be taken to prevent hazards to children.
Care should be taken if conditions are abnormal.

PZU918J

Jungle Tower Installation Instructions

design
make
play

SutcliffePlay



PZU918J

Jungle Tower Installation Instructions

design
make
play
SutcliffePlay



PZU918J

Jungle Tower Installation Instructions

design
make
play

SutcliffePlay



PZU918J

Jungle Tower Parts List

design
make
play
SutcliffePlay

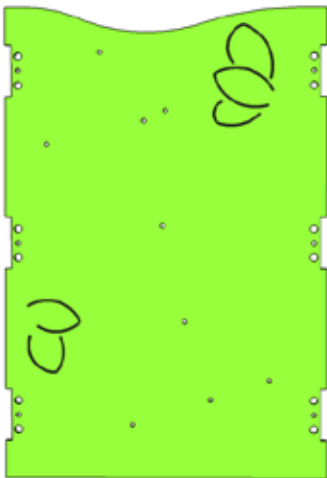

Monkey Base Panel
PZA669 x 1

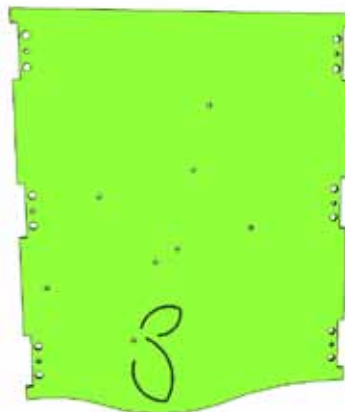

Toucan Base Panel
PZA672 x 1

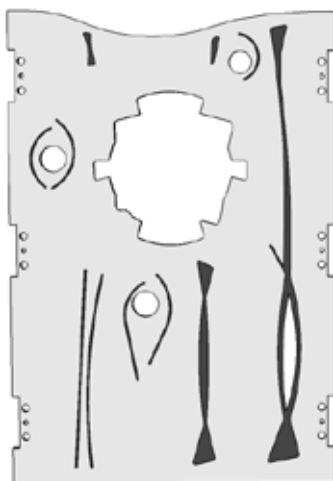

Window Panel
PZA668 x 3

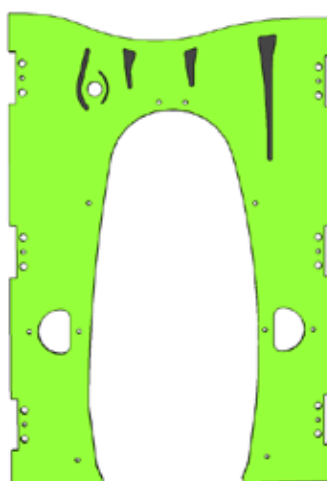

Door Panel
PZA663 x 1

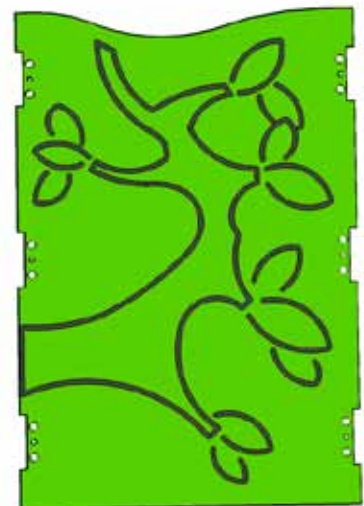

Jungle Panel
PZA671 x 1

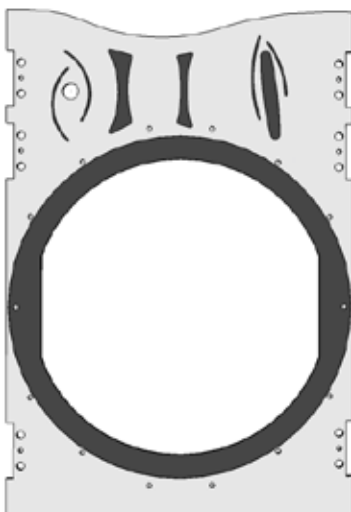

Chute Entrance Panel
PZA675 x 1



Roof Panel
PZA482J x 4

PZU918J

Jungle Tower Parts List

design
make
play
SutcliffePlay

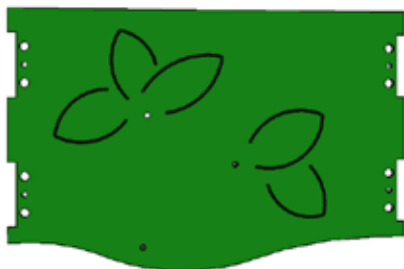

Tree Infill Panel
PZA667 x 4

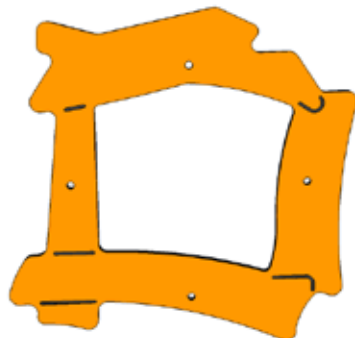

Window Frame Panel
PZA676 x 6



Monkey Panel
PZA666 x 1



Door Frame Left
PZA664 x 1

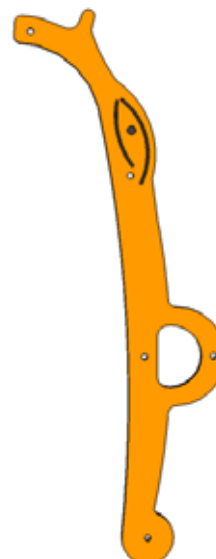

Door Frame Right
PZA665 x 1



Jungle Call Panel
DZA666J x 1

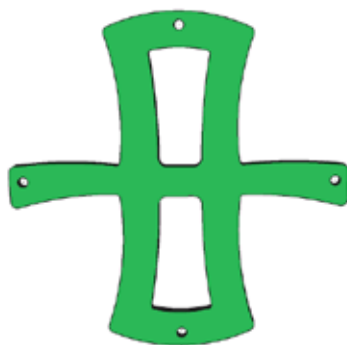

Prison Bars
DZA754 x 3



Wavy Seat Panel
DZA631G x 1

PZU918J

Jungle Tower Parts List

design
make
play
SutcliffePlay

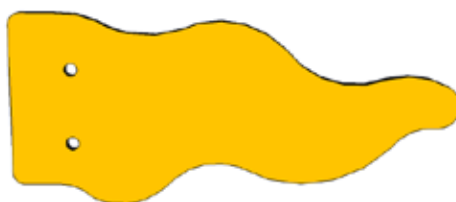

Flag Panel
DZA780 x 1

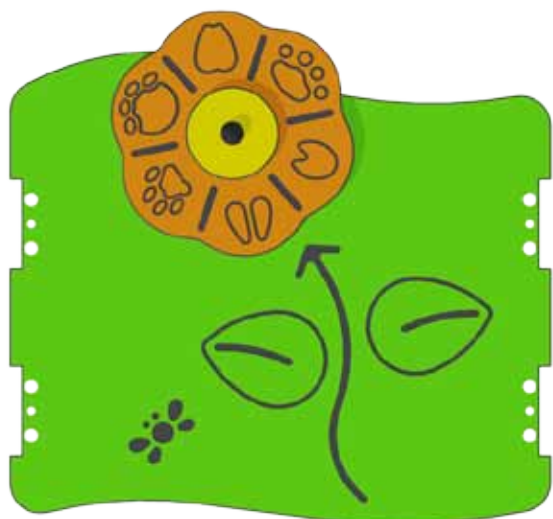

Footprint Finder Assembly
DZA695 x 1



Toucan Body
PZA673 x 1



Monkey Face Panel
PZA670 x 2

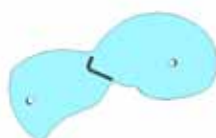

Toucan Wing
PZA674 x 1



Branch Panel A
PZA661 x 6



Branch Panel B
PZA662 x 1



Chute Clamp Panels
DZA734 x 2

PZU918J

Jungle Tower Parts List

design
make
play
SutcliffePlay

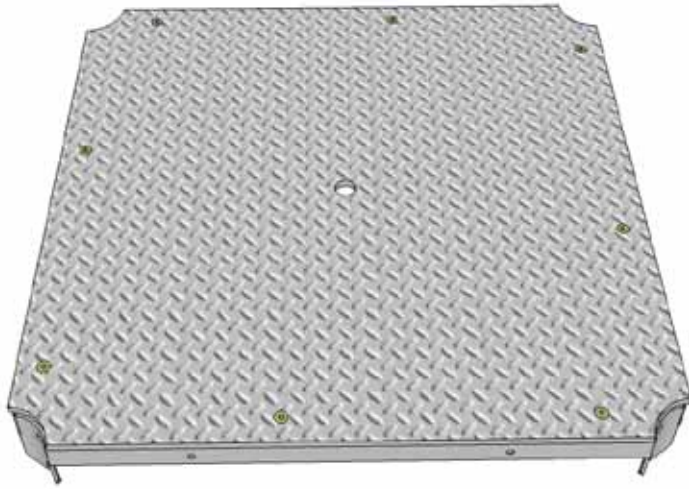

Square Deck
DZD010 x 1

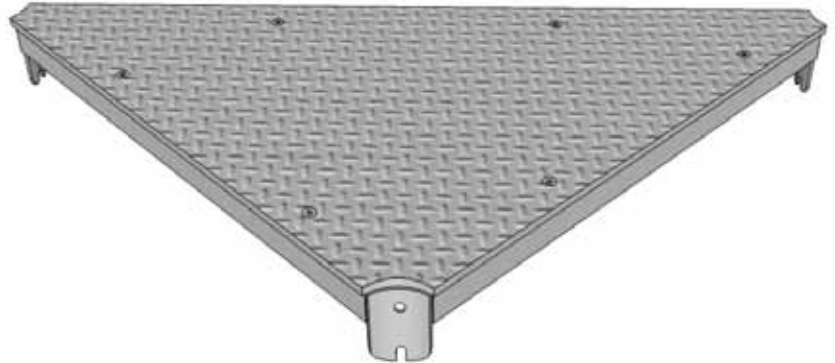

45 Degree Deck
PZB118 x 2



Triangular Deck
DZD020 x 6

PZU918J

Jungle Tower Parts List

design
make
play
SutcliffePlay



Hand Over Hand
PZA232 x 1



1.5M Slide Bars
PZT555 x 1

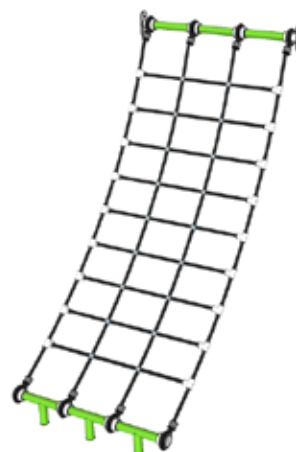

1.5M Scramble Net
PZA400 x 1

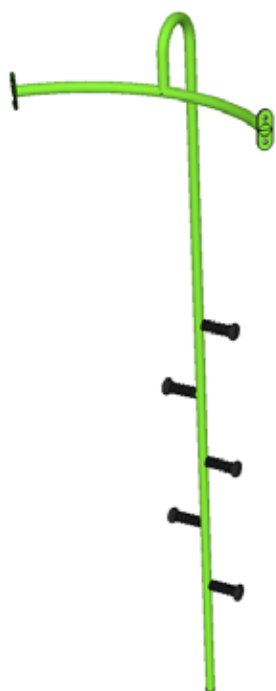

1.8M Pole Climb
PZA530 x 1

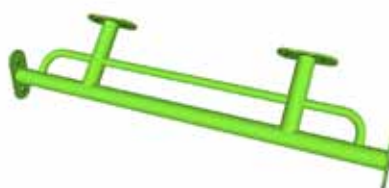

Roof Rails
PZA488 x 4



Wavy Seat Rail
DZA632 x 1

PZU918J

Jungle Tower Parts List

design
make
play
SutcliffePlay

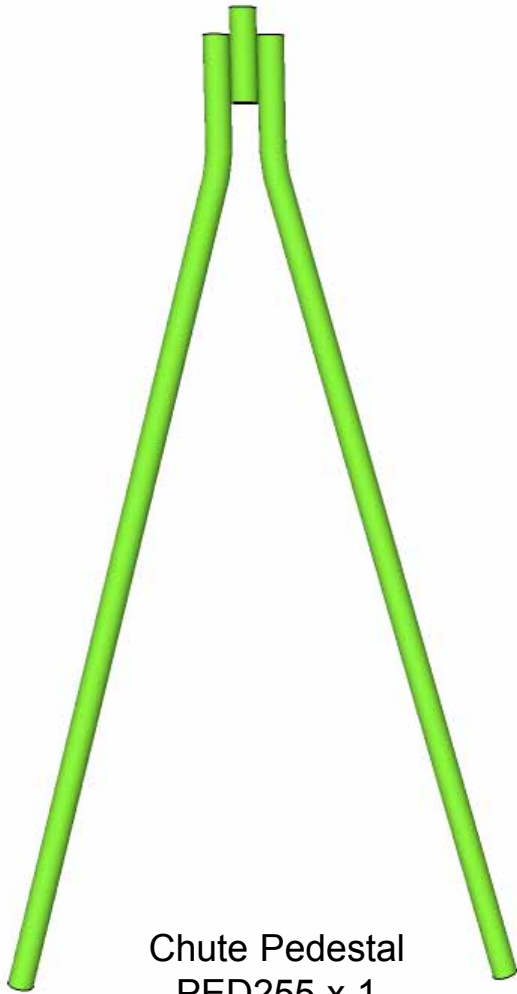

Chute Pedestal
PED255 x 1



Rope Climb Barrier
PZT270 x 1



2.1M Rope Climb
PZA460 x 1

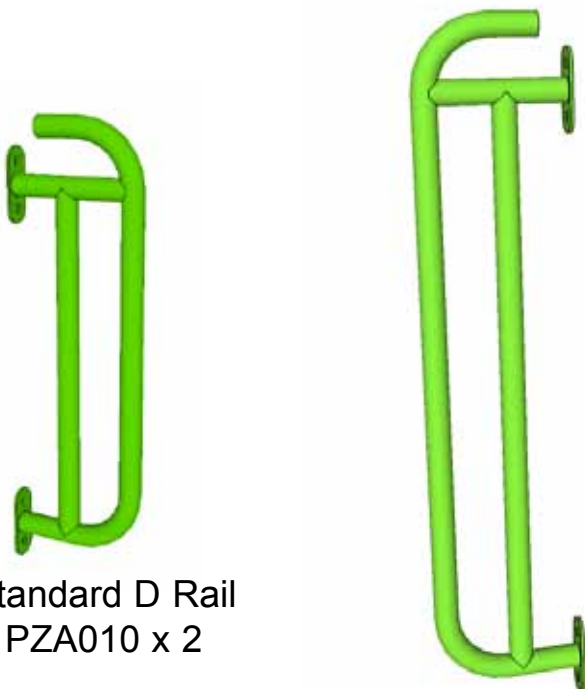

Standard D Rail
PZA010 x 2

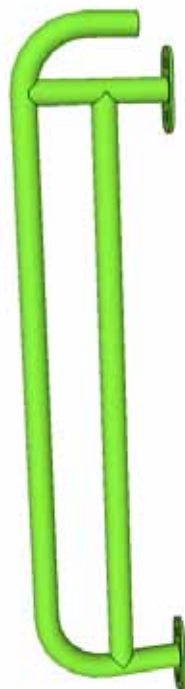

Extended D Rail
PZA766 x 2



Arch Top Rail
PZT226 x 3

PZU918J

Jungle Tower Parts List

design
make
play
SutcliffePlay



1M Single Rung
PZA210 x 3

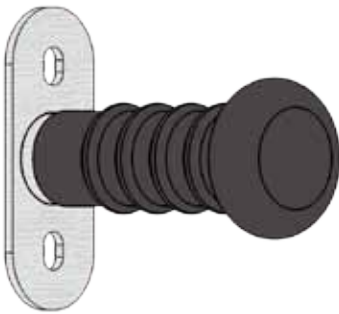

Hand/Foot Holds
PZA220 x 8

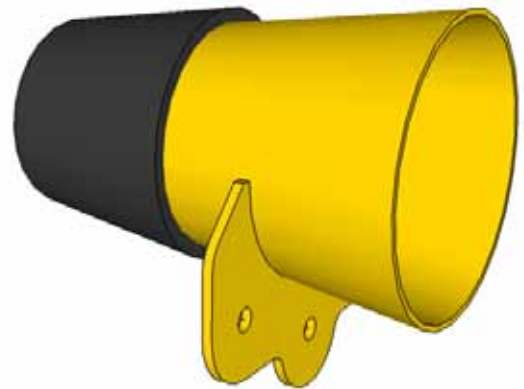

Panel Mounted Megaphone
DZA669 x 1

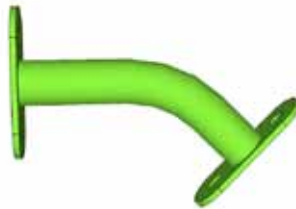

Monkey Talker Bracket
PZA765 x 1



Roof Support Plate
PZS051 x 4



Flag Mast
PZA760 x 1

PZU918J

Jungle Tower Parts List

design
make
play
SutcliffePlay

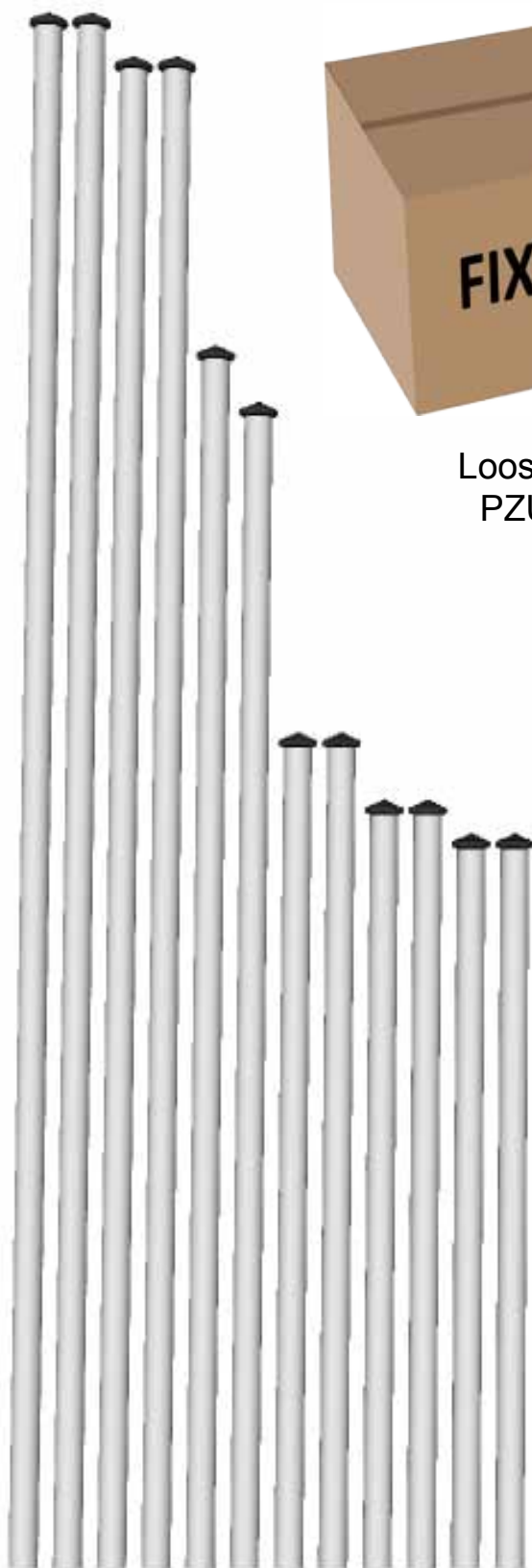

Set Of 12 Posts
PPU918



Loose Fixing Kit
PZU918F x 1

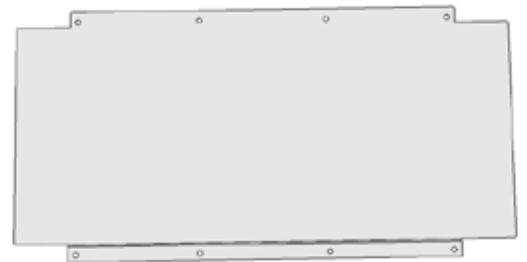

600 x 1.4m Long Deck Infill
DZD360 x 1

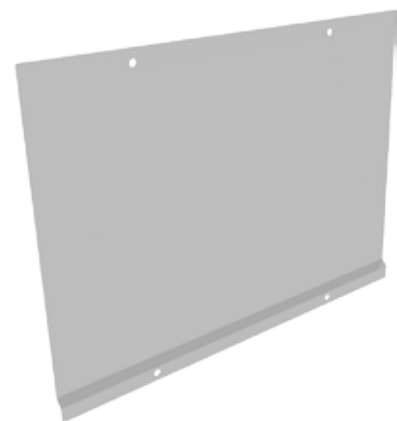

600 x 1.0m Long Deck Infills
DZD320 x 3

PZU918J

Jungle Tower
Parts List

design
make
play
SutcliffePlay

SCP455
3.9m CURVED TUNNEL
CHUTE

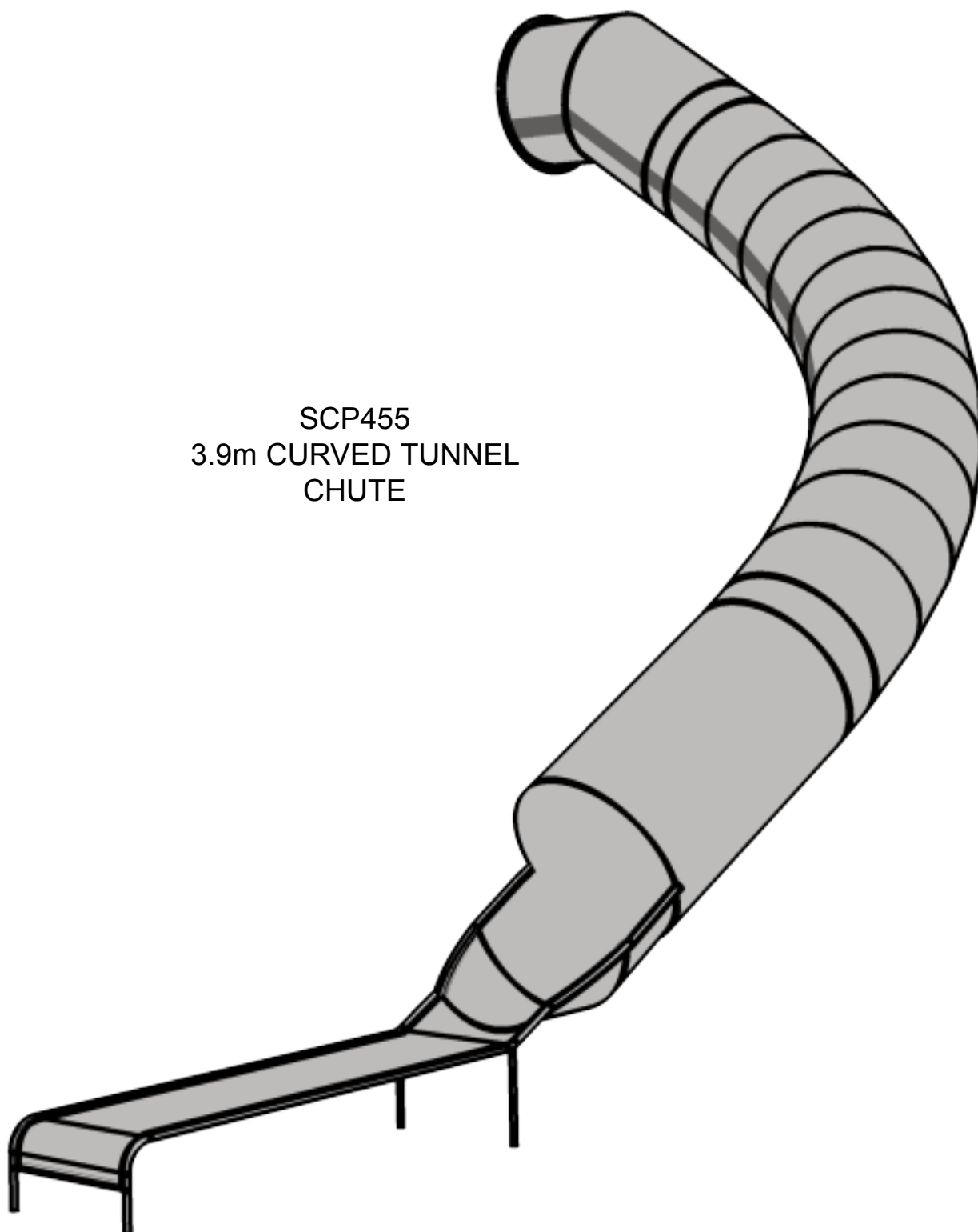

PZU918J

Jungle Tower Deck Positions

design
make
play
SutcliffePlay

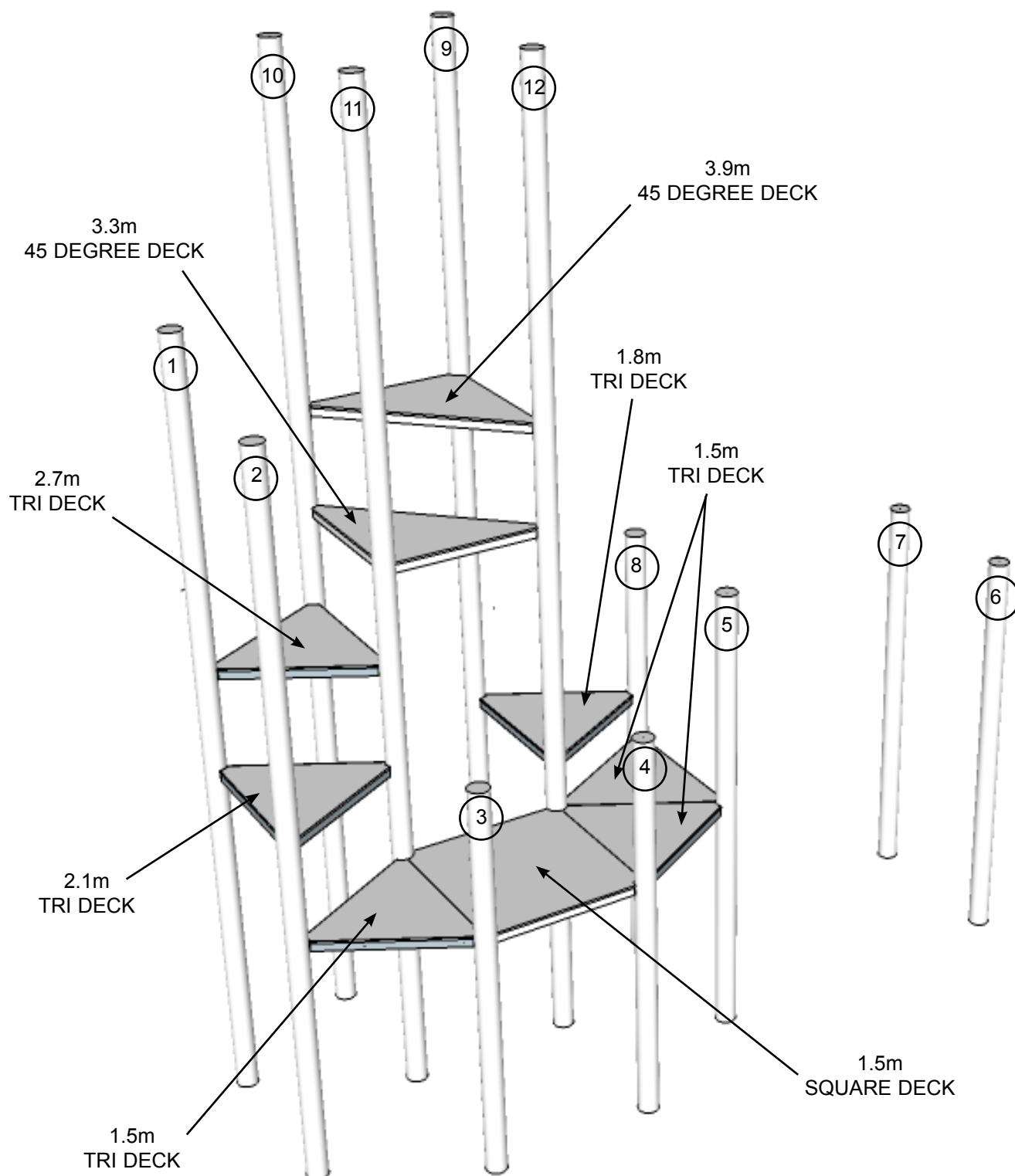

PZU918J

Jungle Tower
Deck Fixings

design
make
play
SutcliffePlay

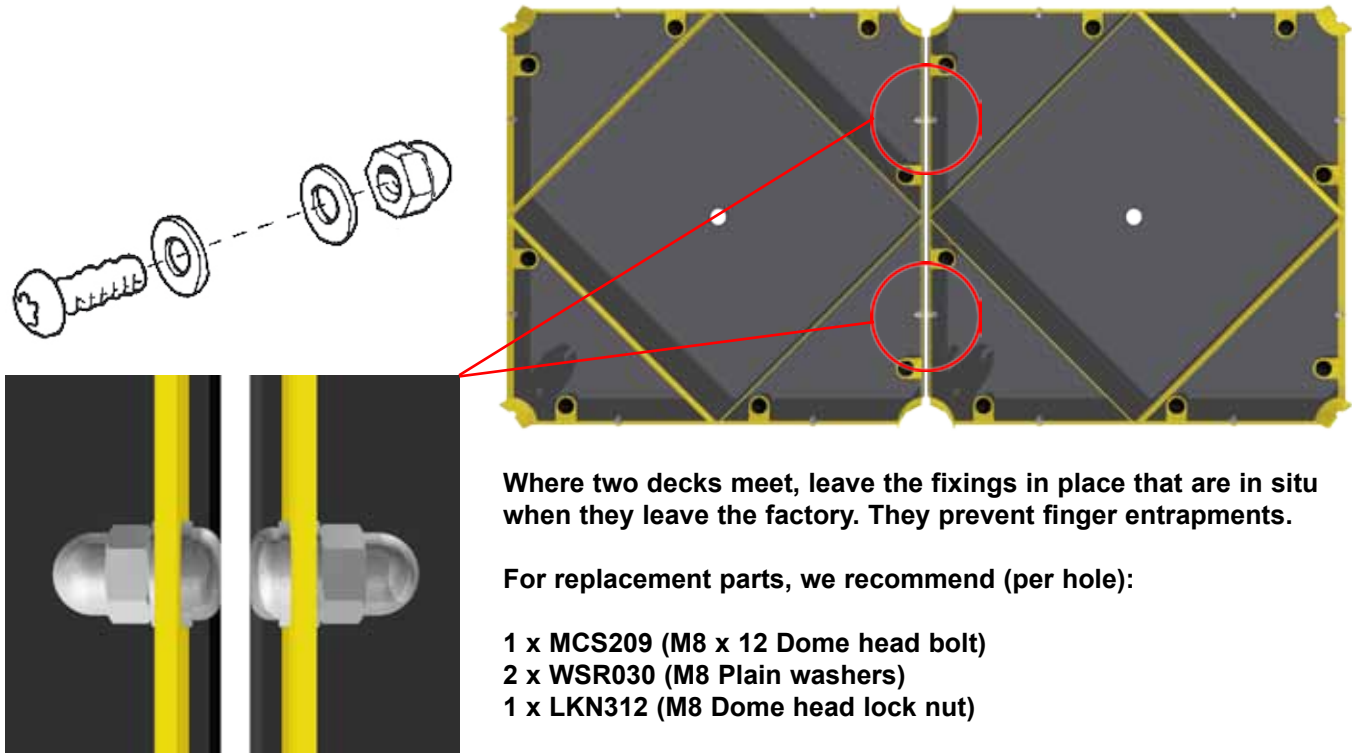
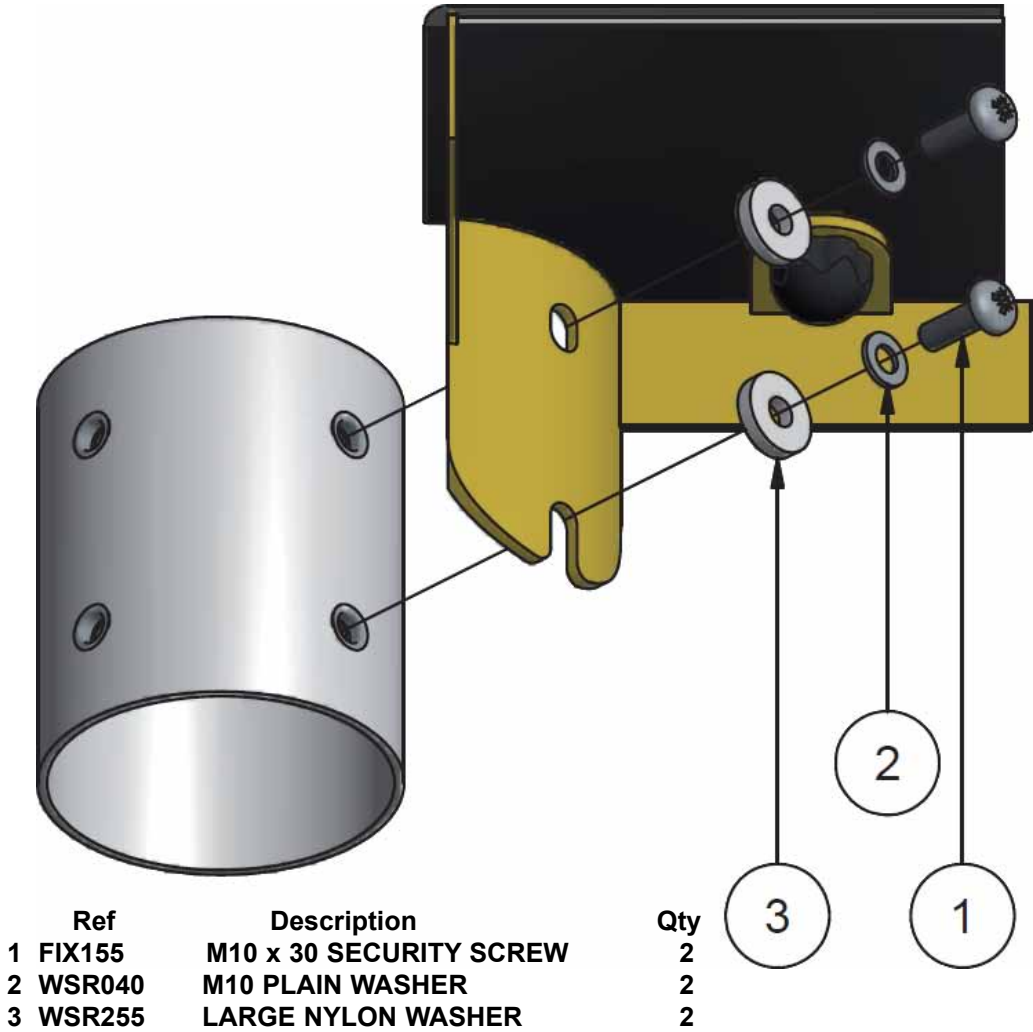

Where two decks meet, leave the fixings in place that are in situ when they leave the factory. They prevent finger entrapments.

For replacement parts, we recommend (per hole):

- 1 x MCS209 (M8 x 12 Dome head bolt)
- 2 x WSR030 (M8 Plain washers)
- 1 x LKN312 (M8 Dome head lock nut)

PZU918J

Jungle Tower
Panel Fixings

design
make
play
SutcliffePlay

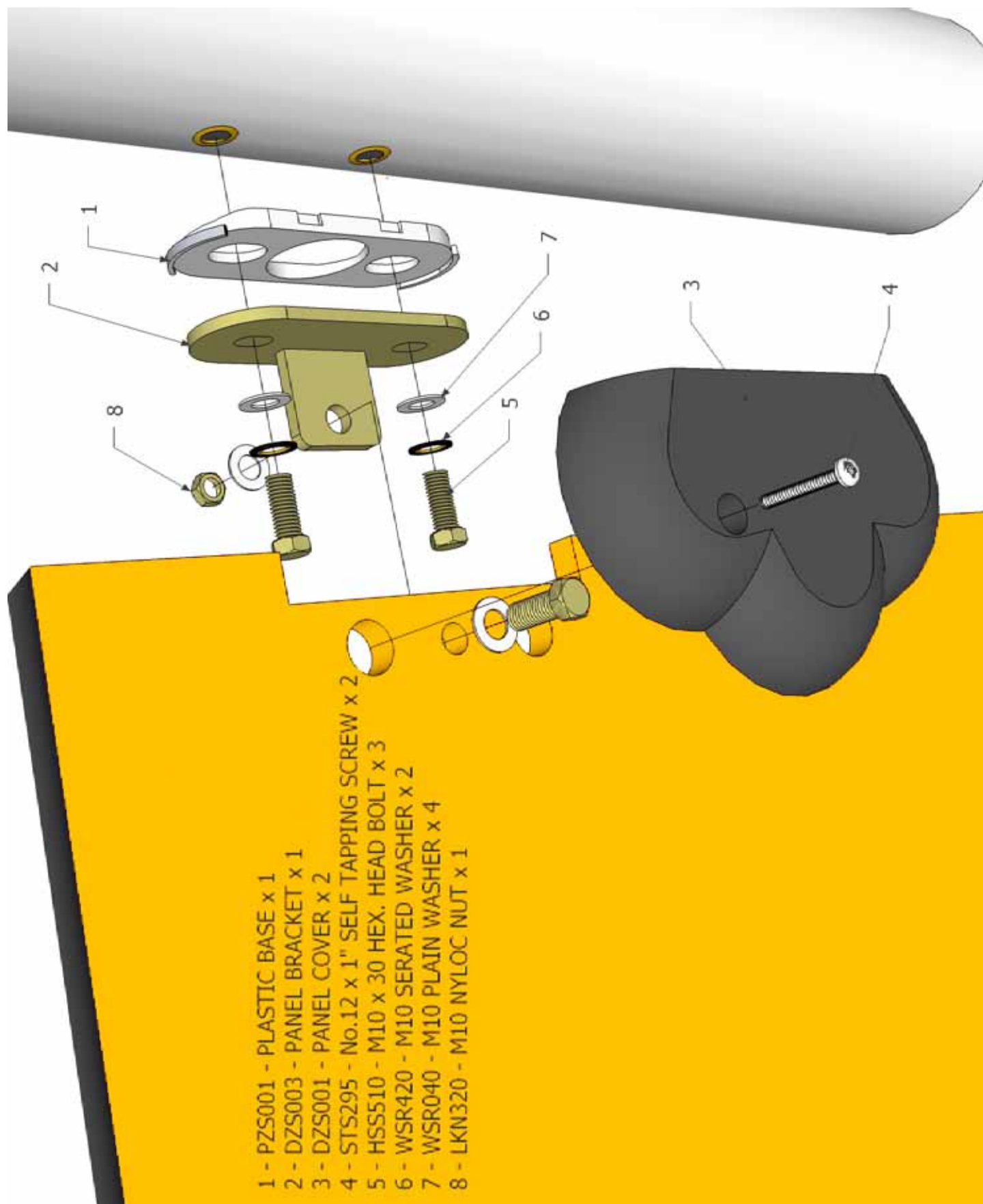

PZU918J

Jungle Tower
Activity To Post fixings

design
make
play
SutcliffePlay

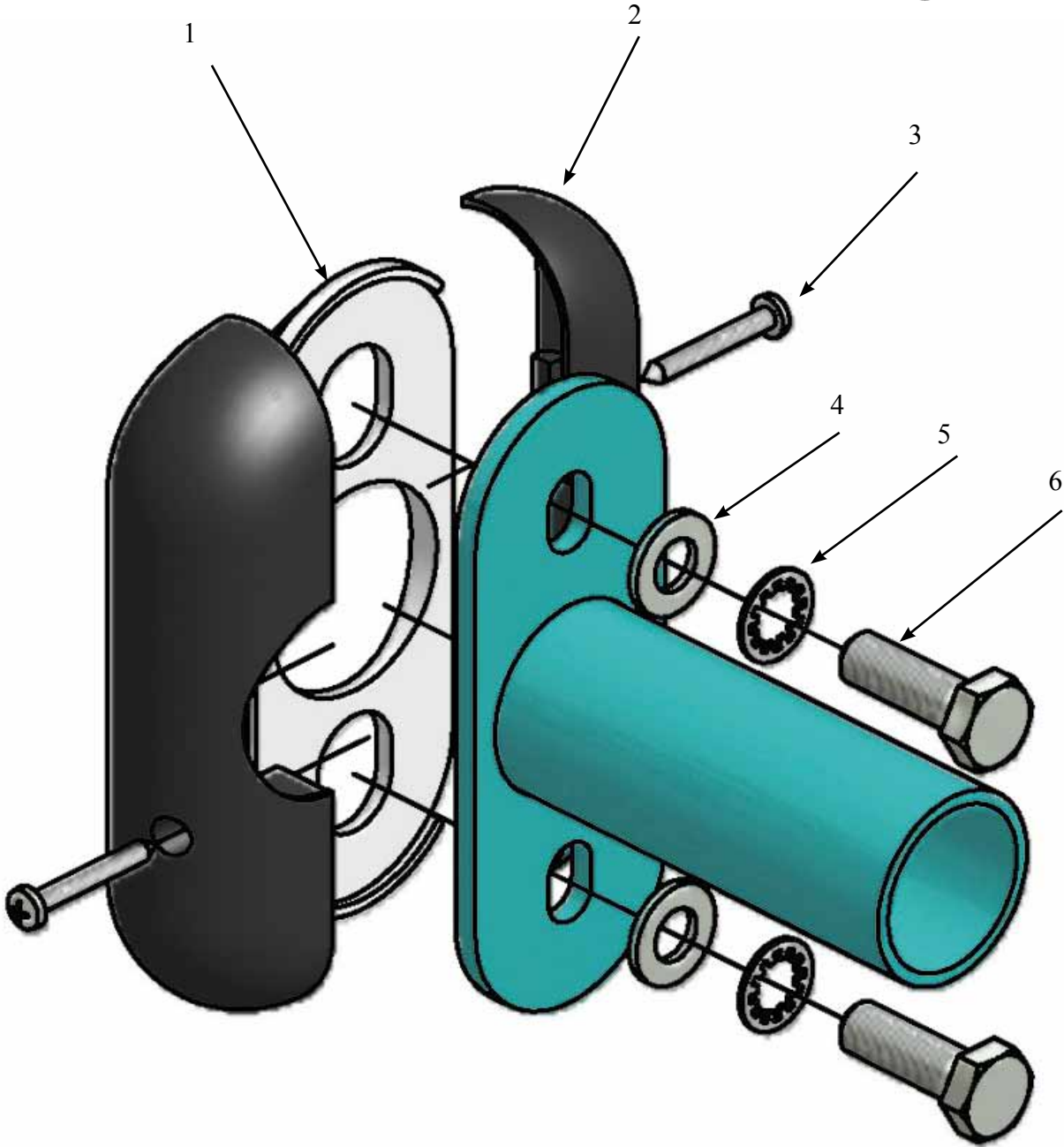

Ref	Description	Qty
1 - PZS001	Nylon Base	1
2 - DZS007	Plastic Cover (Pair)	1
3 - STS060	No.8 x 32 Long Screw	2
4 - WSR040	M10 Plain Washer	2
5 - WSR420	M10 Serated Washer	2
6 - HSS510	M10 Hex Head Screw	2

PZU918J

Jungle Tower

design
make
play
SutcliffePlay

DOOR PANEL FIXINGS

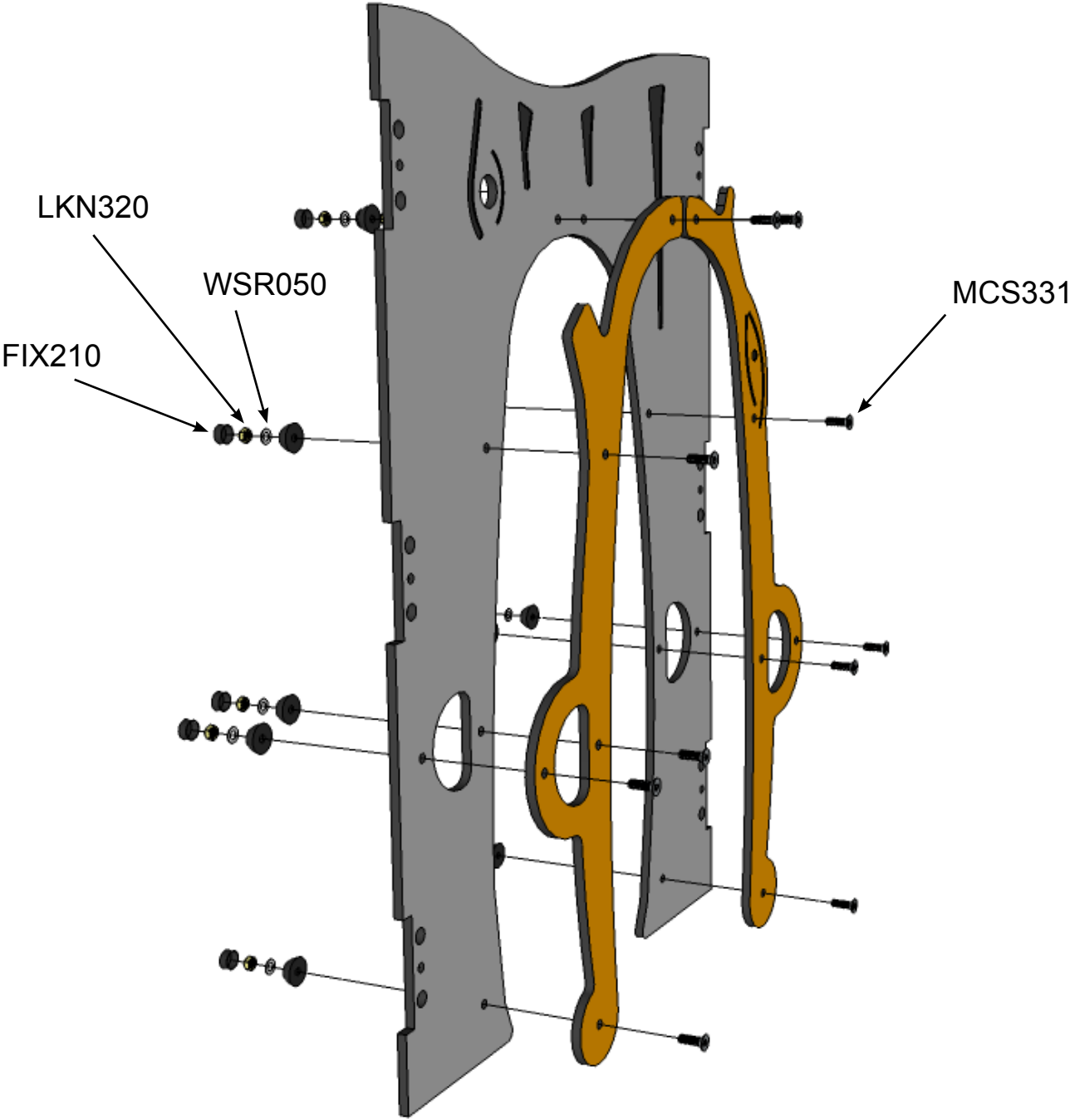

Code	Description	Qty
MCS331	M10 x 45 Countersunk Screw	10
LKN320	M10 Nylock Nut	10
FIX210	2 Part Nut Cover	10
WSR050	Plain Washer	10

PZU918J

Jungle Tower

design
make
play
SutcliffePlay

MONKEY PANEL FIXINGS

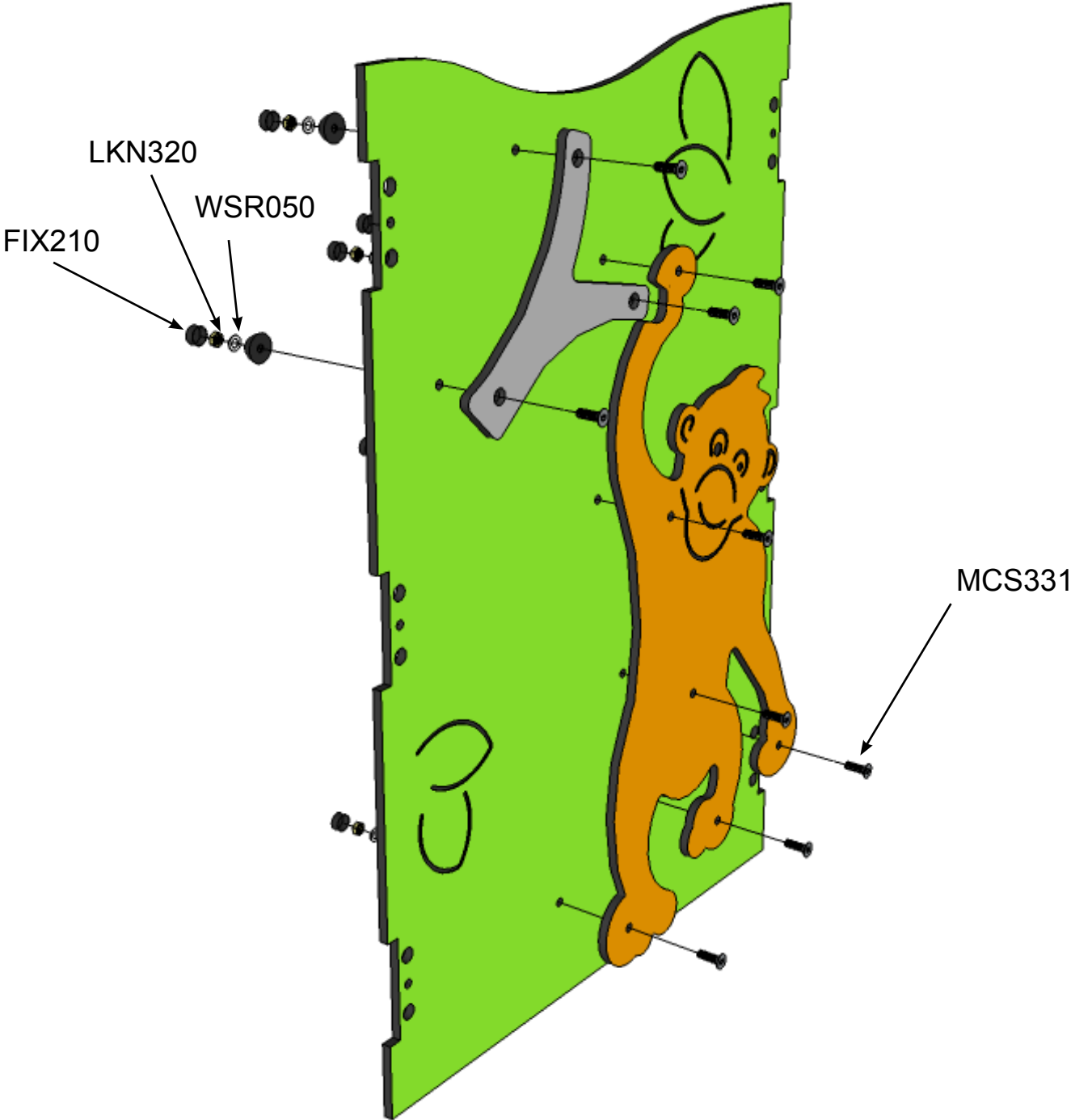

Code	Description	Qty
MCS331	M10 x 45 Countersunk Screw	9
LKN320	M10 Nylock Nut	9
FIX210	2 Part Nut Cover	9
WSR050	Plain Washer	9

PZU918J

Jungle Tower

design
make
play
SutcliffePlay

WINDOW PANEL FIXINGS

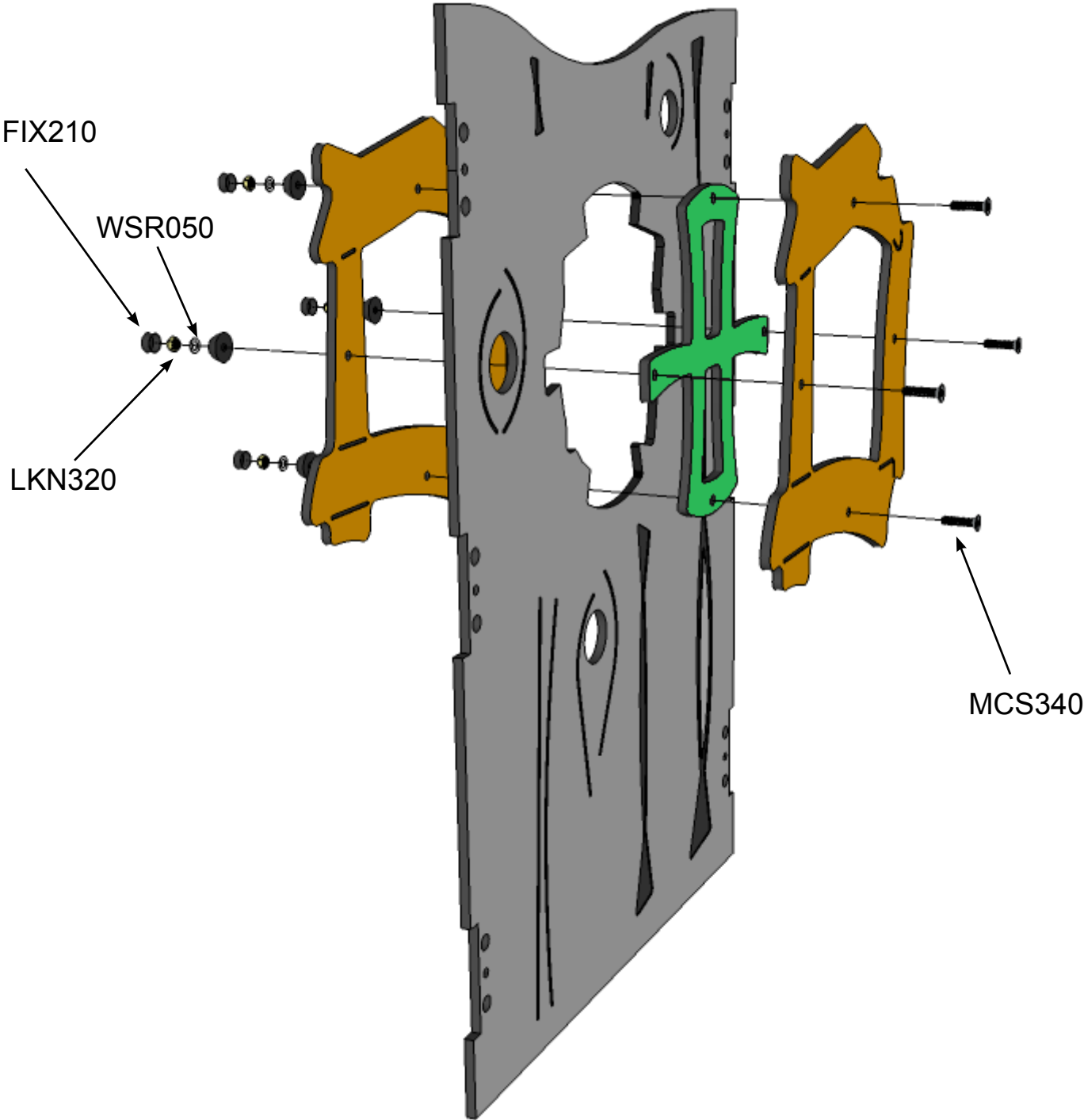

Code	Description	Qty
MCS340	M10 x 55 Countersunk Screw	9
LKN320	M10 Nylock Nut	9
FIX210	2 Part Nut Cover	9
WSR050	Plain Washer	9

TOUCAN PANEL FIXINGS

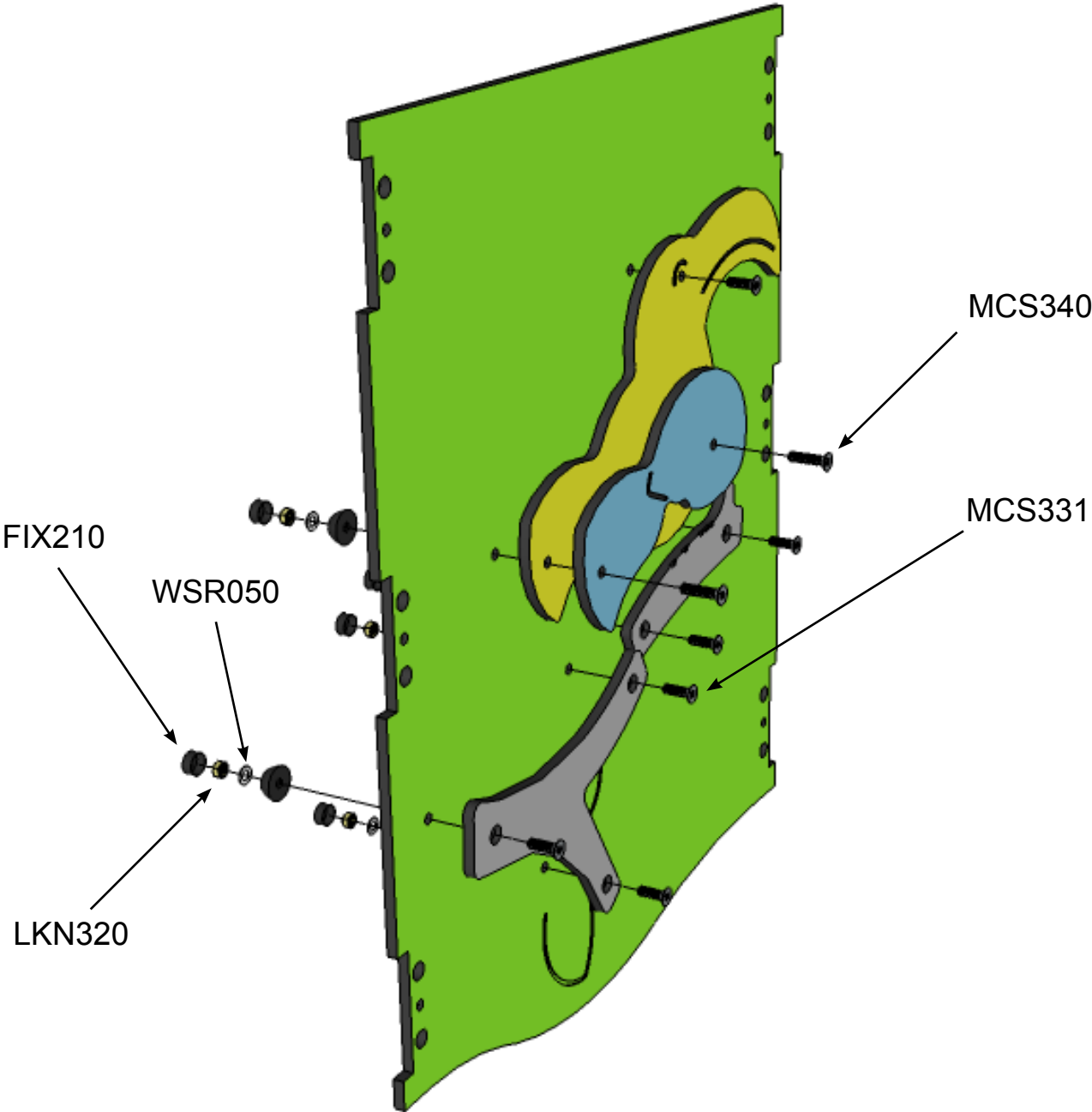

Code	Description	Qty
MCS340	M10 x 55 Countersunk Screw	2
MCS331	M10 x 45 Countersunk Screw	6
LKN320	M10 Nylock Nut	8
FIX210	2 Part Nut Cover	8
WSR050	Plain Washer	8

PZU918J

Jungle Tower

design
make
play
SutcliffePlay

JUNGLE CALL PANEL FIXINGS

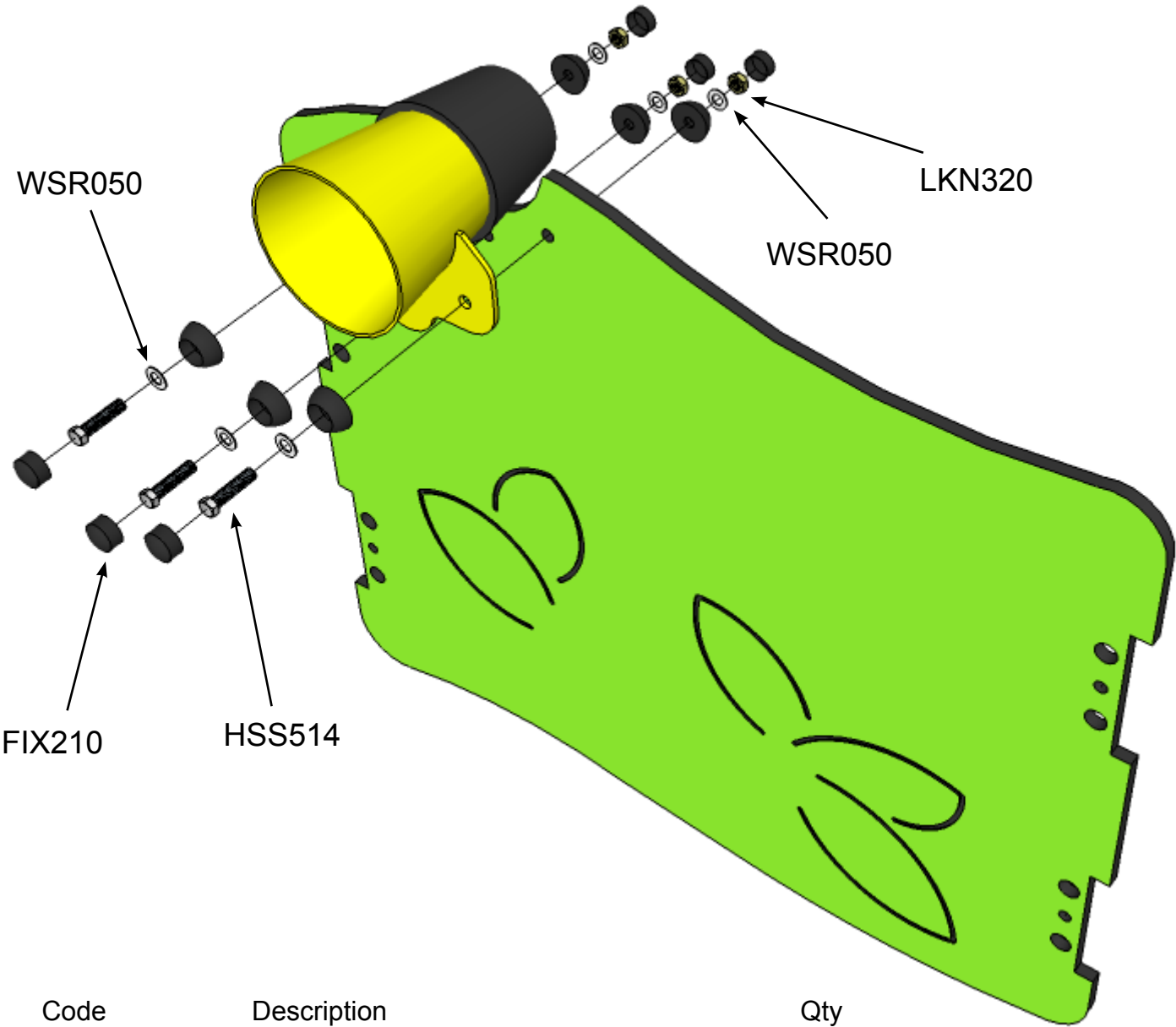

Code	Description	Qty
HSS514	M10 x 40 Hex Head Screw	3
LKN320	M10 Nylock Nut	3
FIX210	2 Part Nut Cover	6
WSR050	Plain Washer	6

PZU918J

Jungle Tower

design
make
play
SutcliffePlay

WAVY SEAT FIXINGS

MCS321

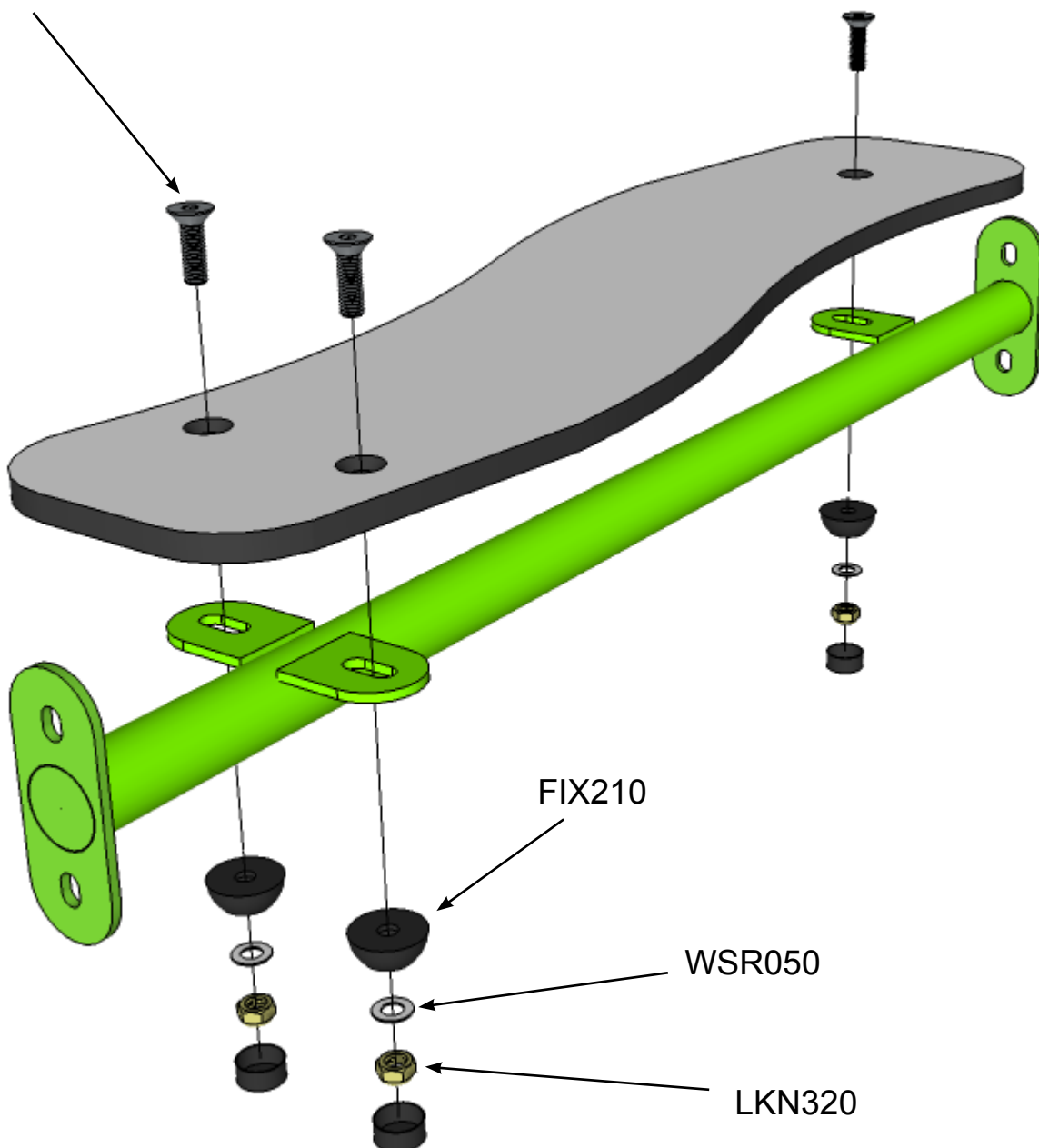

FIX210

WSR050

LKN320

Code	Description	Qty
MCS321	M10 x 35 Countersunk Screw	3
LKN320	M10 Nylock Nut	3
FIX210	2 Part Nut Cover	3
WSR050	Plain Washer	3

TREE INFILL PANEL FIXINGS

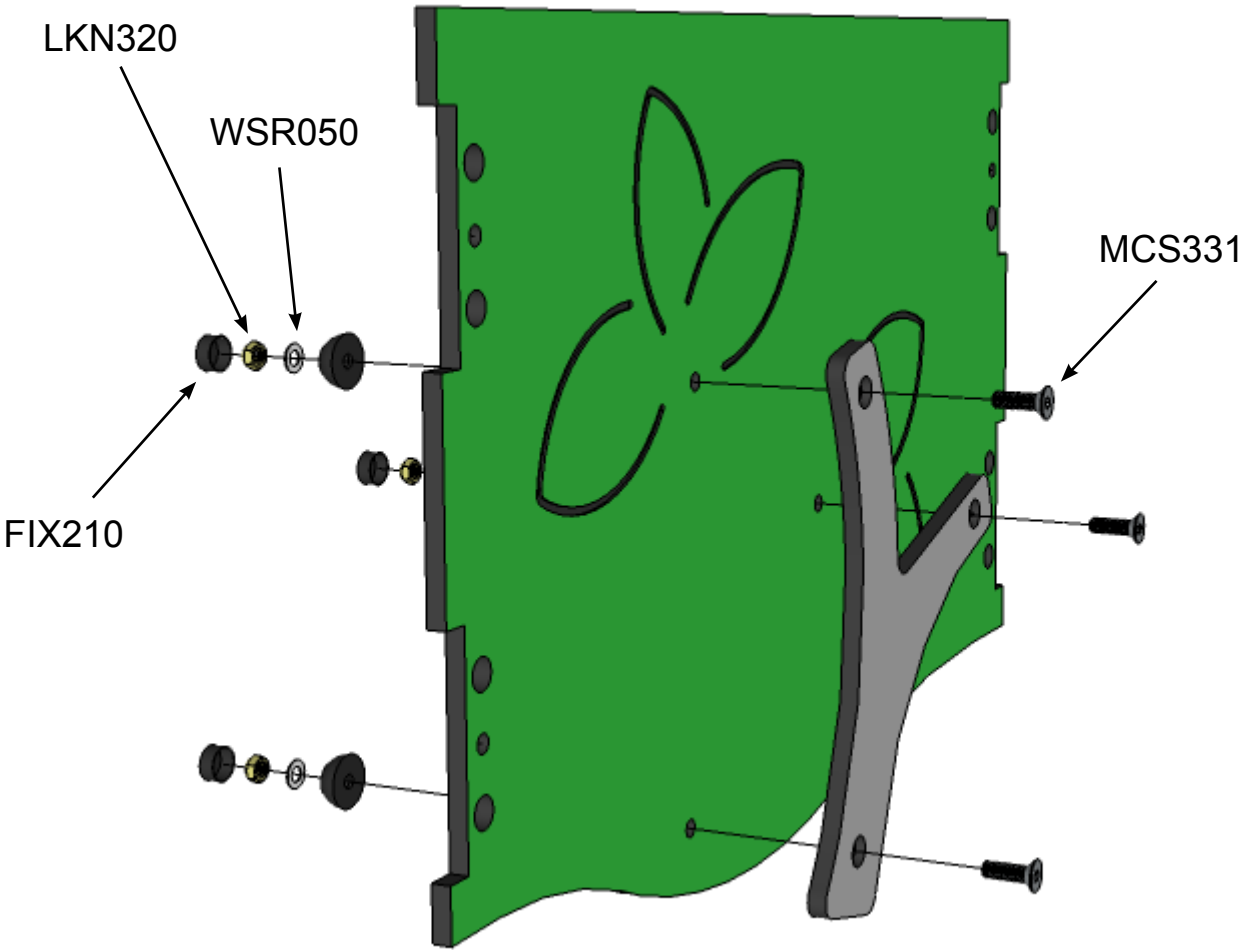

Code	Description	Qty
MCS331	M10 x 45 Countersunk Screw	3
LKN320	M10 Nylock Nut	3
FIX210	2 Part Nut Cover	3
WSR050	Plain Washer	3

PZU918J

Jungle Tower

design
make
play
SutcliffePlay

MONKEY TALKER FIXINGS

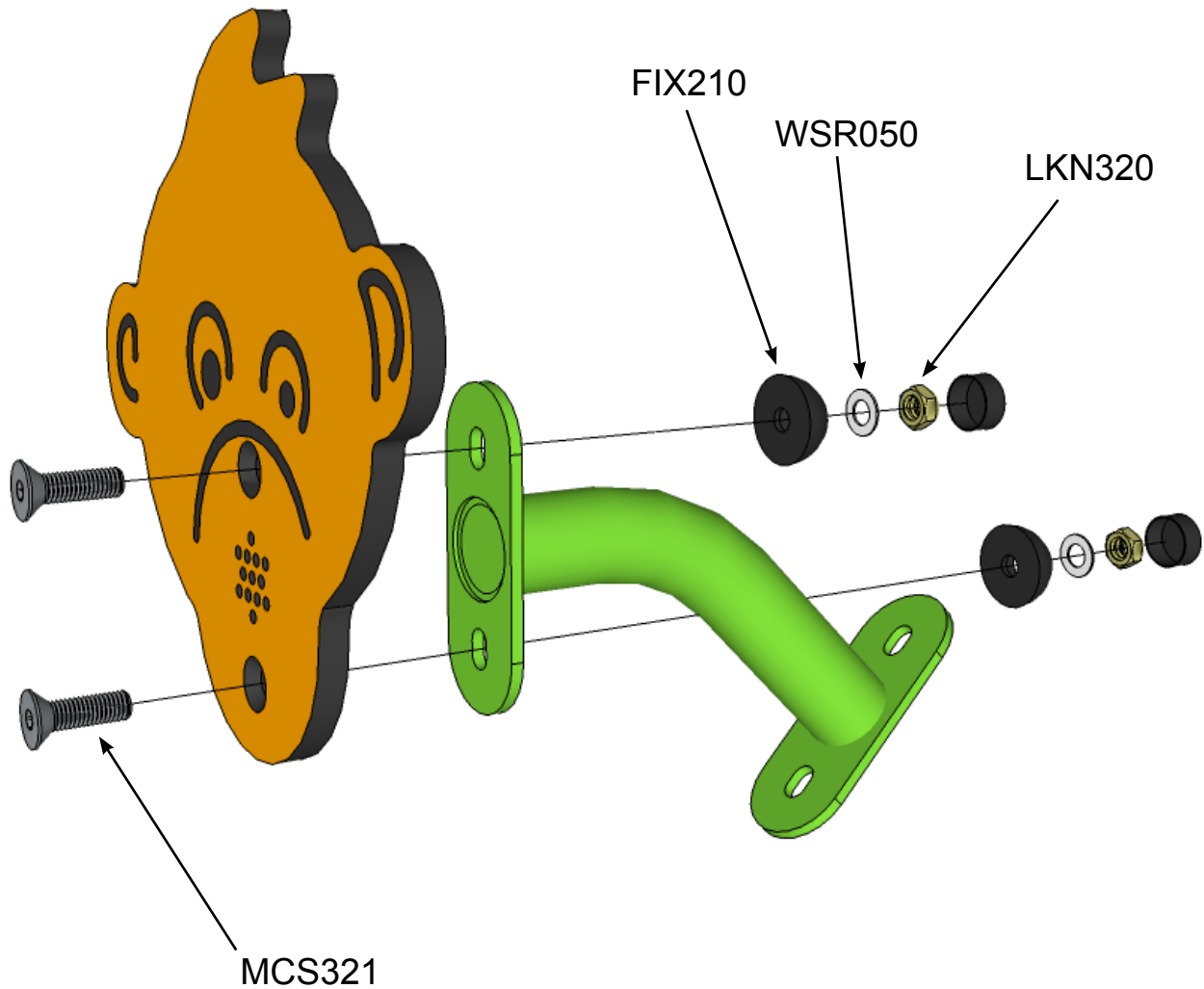

Code	Description	Qty
MCS321	M10 x 35 Countersunk Screw	2
LKN320	M10 Nylock Nut	2
FIX210	2 Part Nut Cover	2
WSR050	Plain Washer	2

PZU918J

Jungle Tower

MONKEY TALKER POST FIXINGS

design
make
play
SutcliffePlay

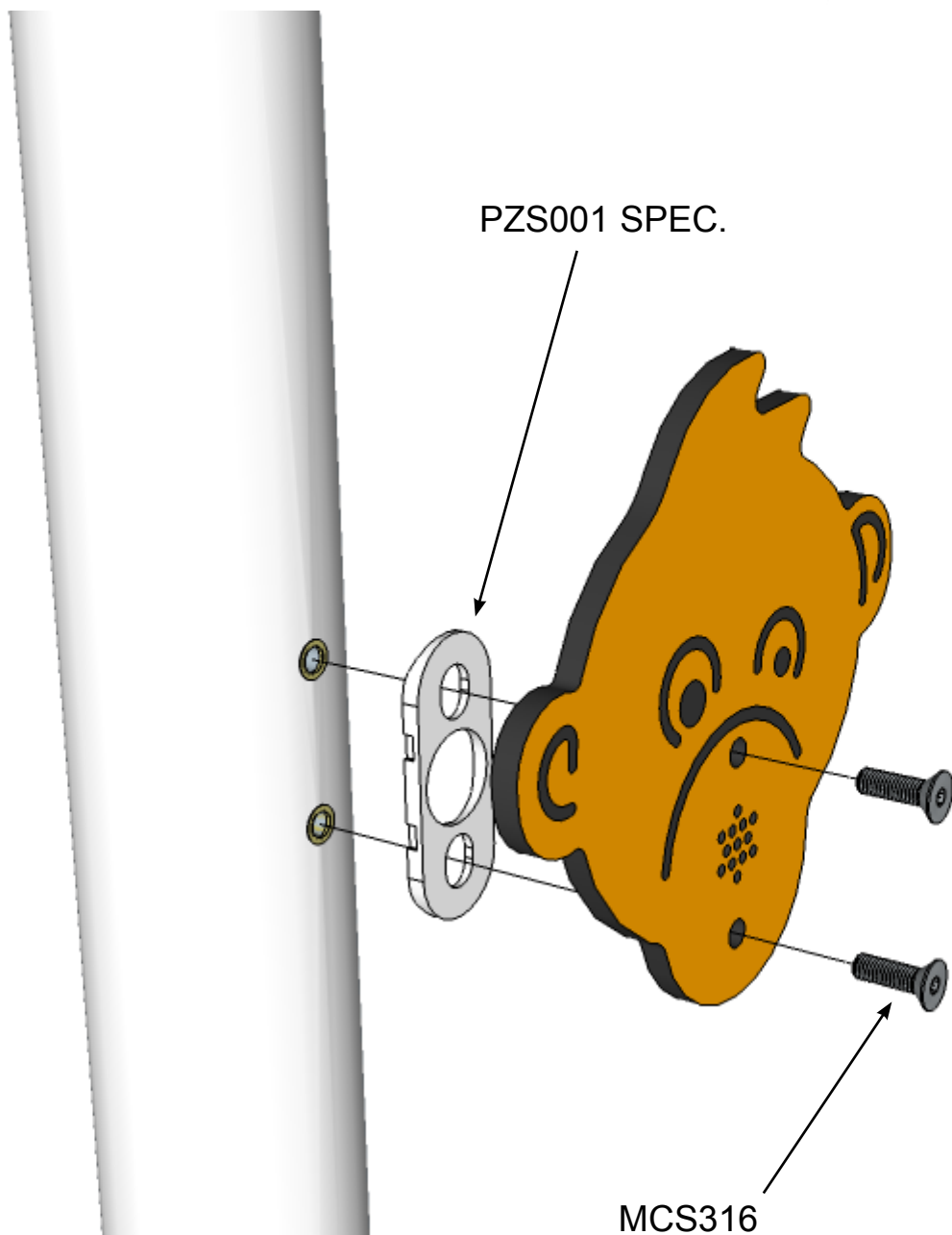

Code	Description	Qty
MCS316	M10 x 30 Countersunk Screw	2
PZS001Spec.	Special Plastic Base	1

PZU918J

Jungle Tower

design
make
play
SutcliffePlay

ROOF FIXINGS

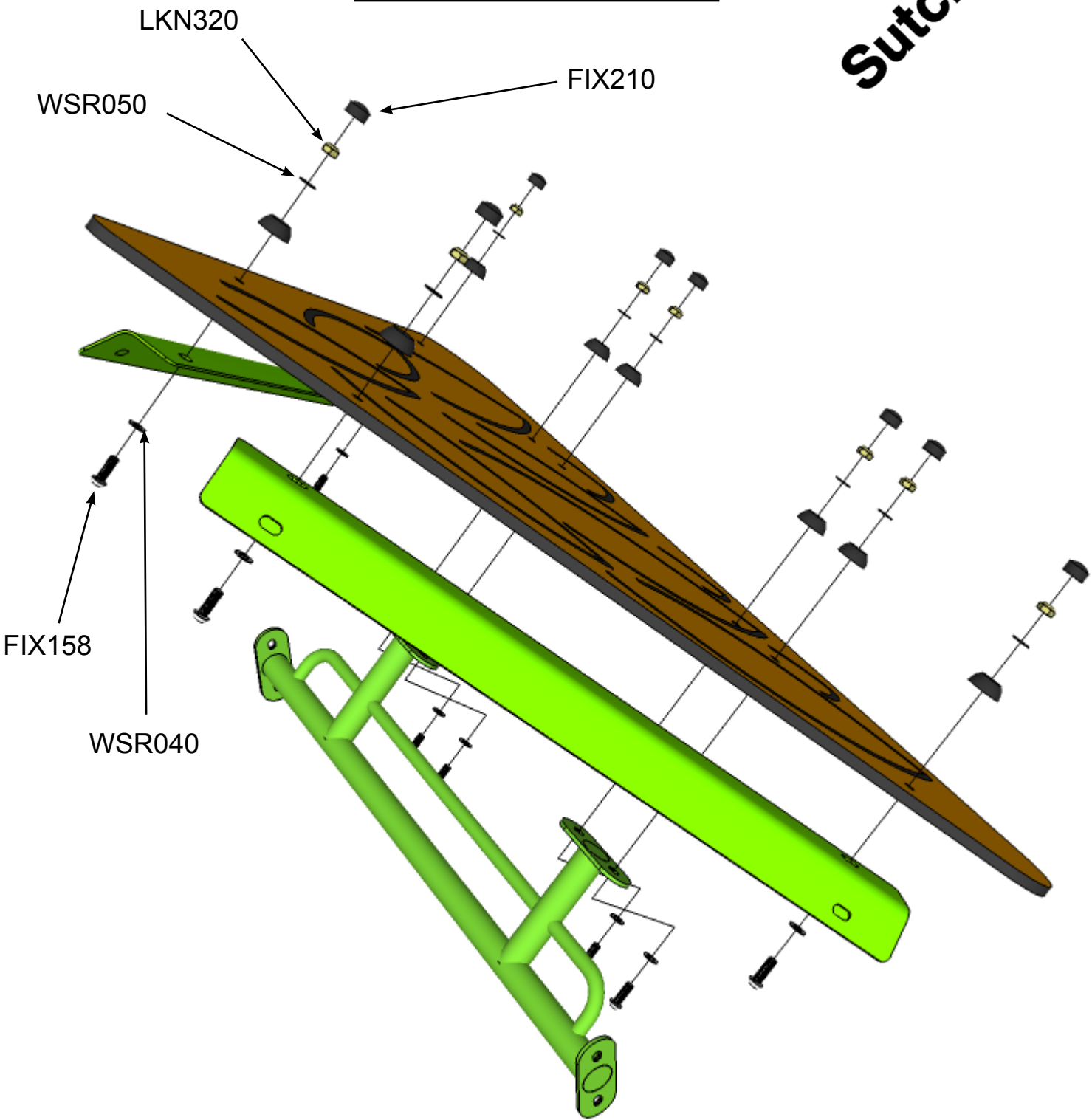

Code	Description	Qty
FIX158	M10 x 35 Security Screw	8
LKN320	M10 Nylock Nut	8
FIX210	2 Part Nut Cover	8
WSR050	Plain Washer	8
WSR040	M10 Washer	8

PZU918J

Jungle Tower

ROOF WITH MAST FIXINGS

design
make
play

SutcliffePlay

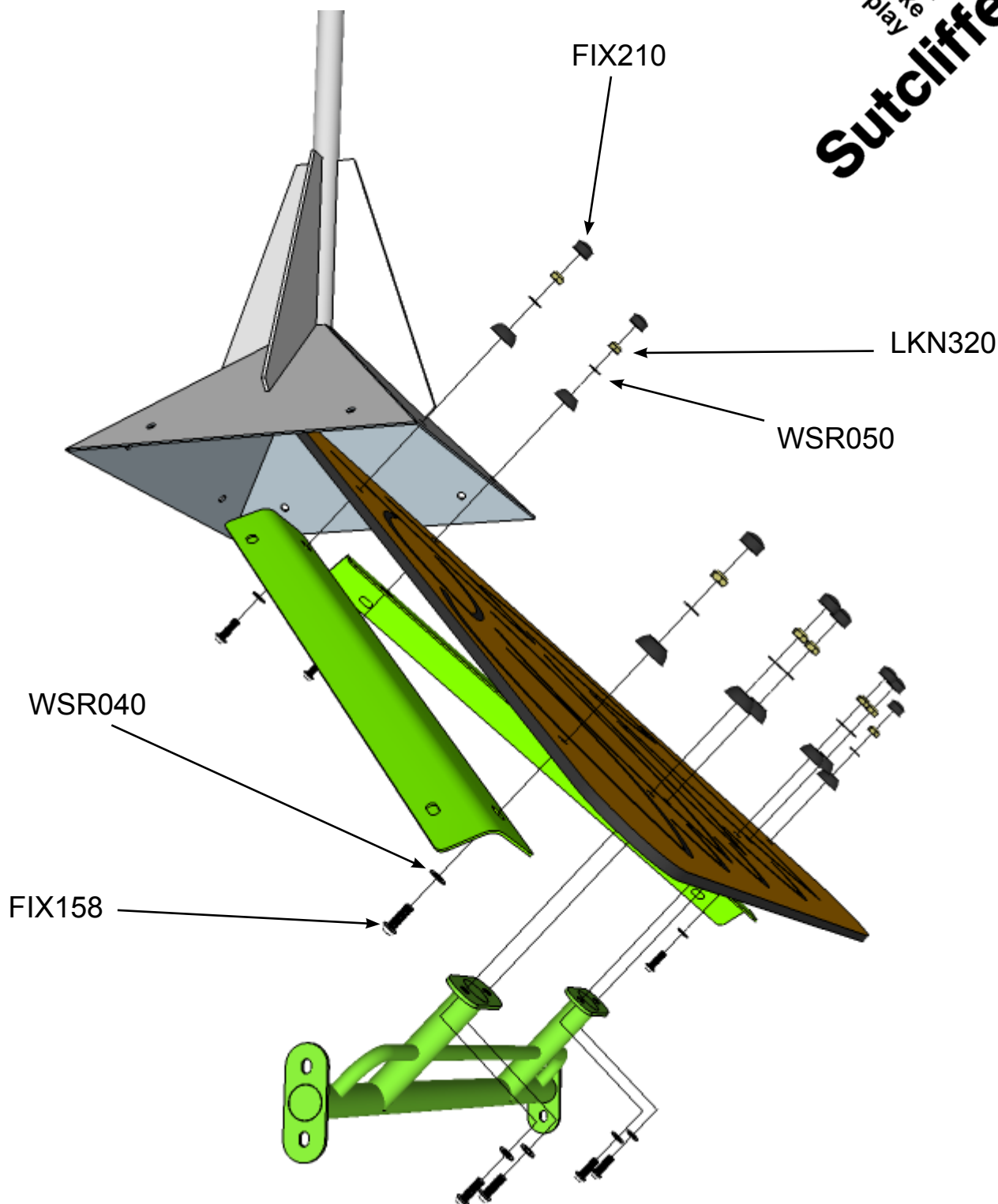

Code	Description	Qty
FIX158	M10 x 35 Security Screw	8
LKN320	M10 Nylock Nut	8
FIX210	2 Part Nut Cover	8
WSR050	Plain Washer	8
WSR040	M10 Washer	8

PZU918J

Jungle Tower

FLAG FIXINGS

design
make
play
SutcliffePlay

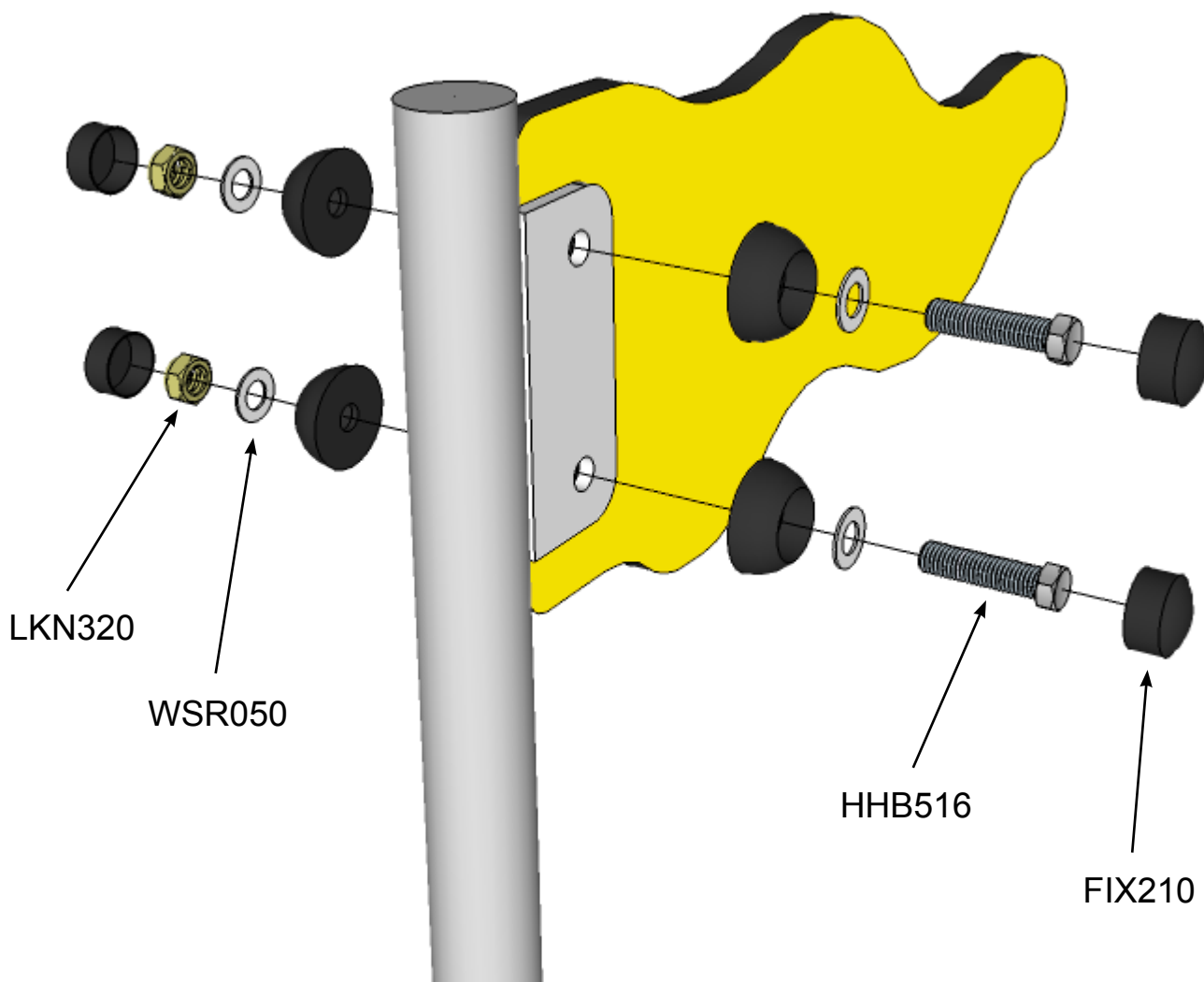

Code	Description	Qty
HHB516	M10 x 45 Hex Head Bolt	2
LKN320	M10 Nylock Nut	2
FIX210	2 Part Nut Cover	4
WSR050	Plain Washer	4

PZU918J

Jungle Tower

CHUTE ENTRANCE FIXINGS

design
make
play

SutcliffePlay

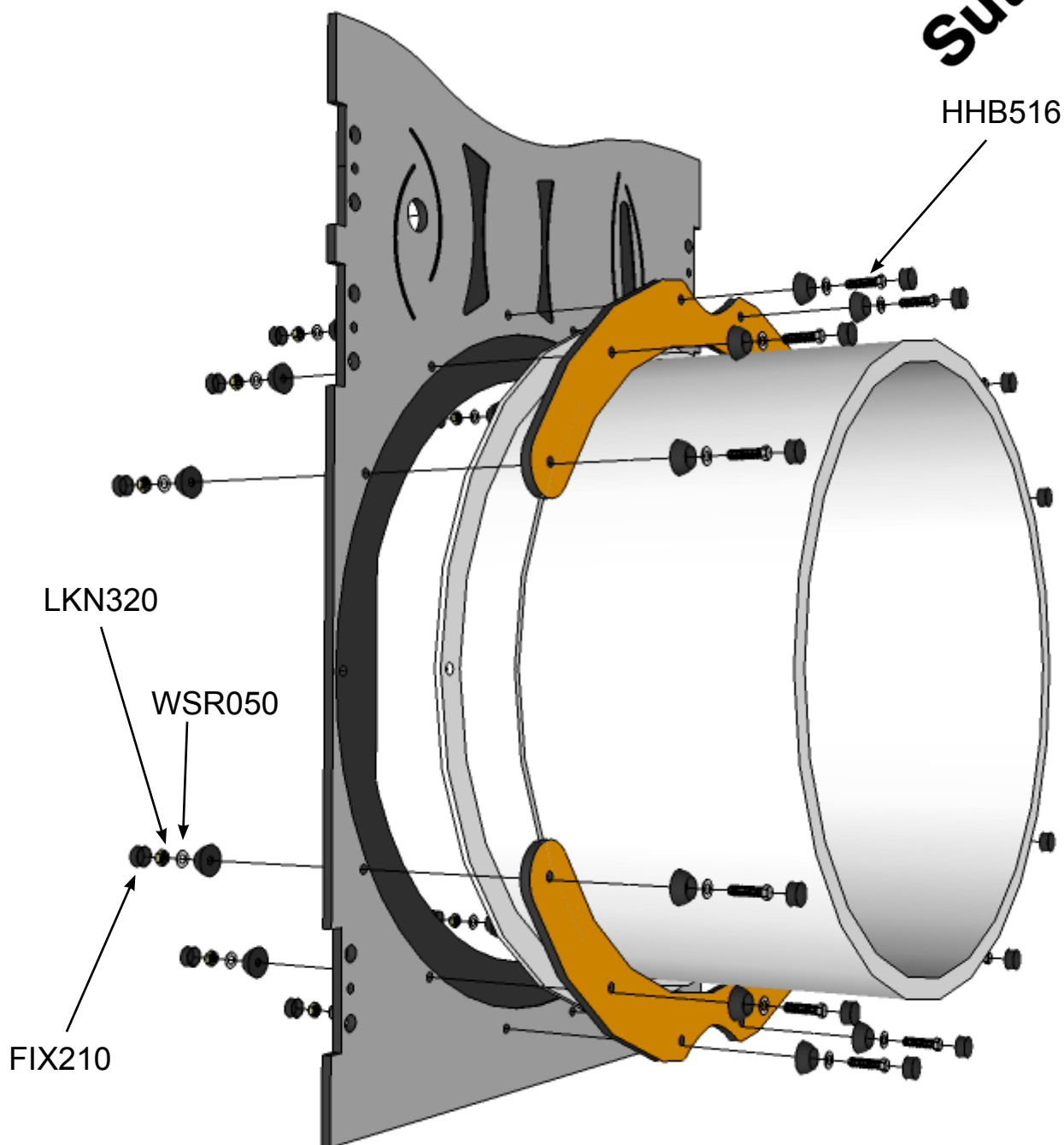

Code	Description	Qty
HHB516	M10 x 45 Hex Head Bolt	12
LKN320	M10 Nylock Nut	12
FIX210	2 Part Nut Cover	24
WSR050	Plain Washer	24

**FINAL POSITION CHUTE
ENTRANCE FIXINGS**

design
make
play
SutcliffePlay

WHEN THE FINAL POSITIONING OF THE
CHUTE IS COMPLETE, DRILL 2 off 12mm
Dia. HOLES THROUGH THE CHUTE FIXING
FLANGE AND FIX IN PLACE AS SHOWN

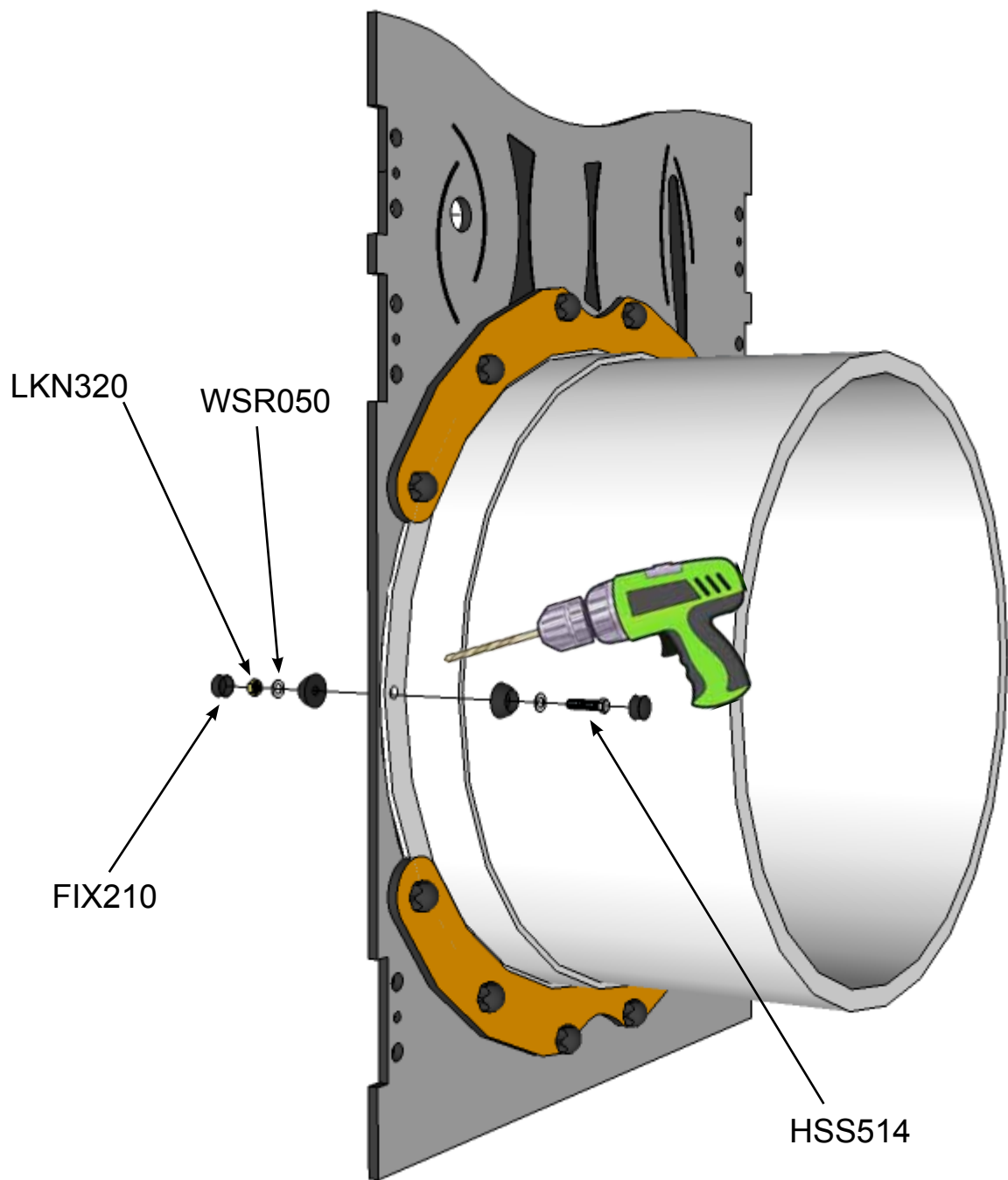

Code	Description	Qty
HSS514	M10 x 40 Hex Head Screw	2
LKN320	M10 Nylock Nut	2
FIX210	2 Part Nut Cover	4
WSR050	Plain Washer	4

PZU918J

Jungle Tower

design
make
play
SutcliffePlay

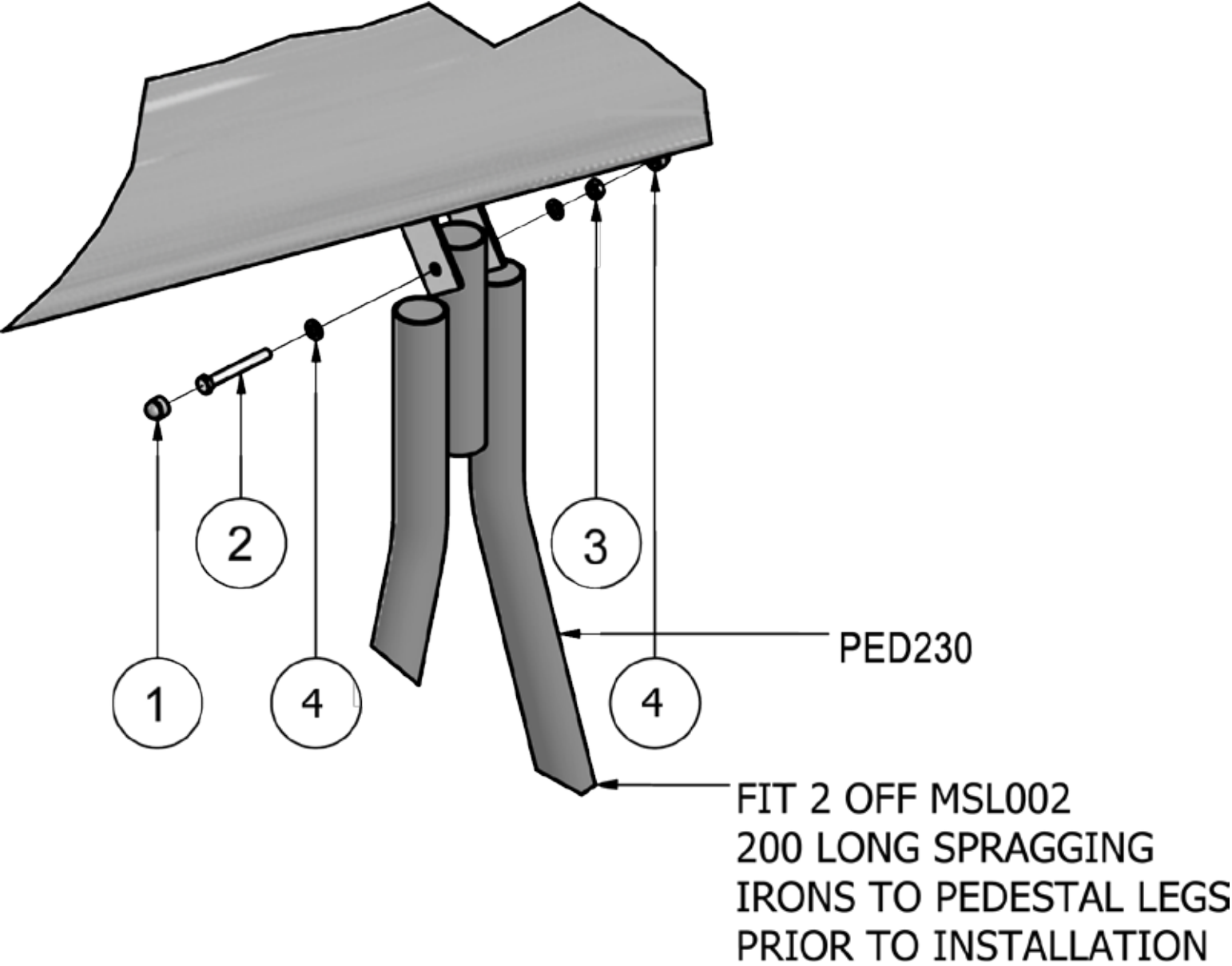

FIXING LIST			
ITEM	STOCK CODE	DESCRIPTION	QTY
1	FIX205	M12 NUT COVER	2
2	HHB638	M12 x 100 HEX HEAD BOLT	1
3	LKN330	M12 NYLOC NUT	1
4	WSR050	M12 PLAIN WASHER	2
	MSL002	SPRAGGING IRON 200 LONG	2

PZU918J

Jungle Tower

CHUTE JOINT FIXING ASSEMBLY

design
make
play
SutcliffePlay

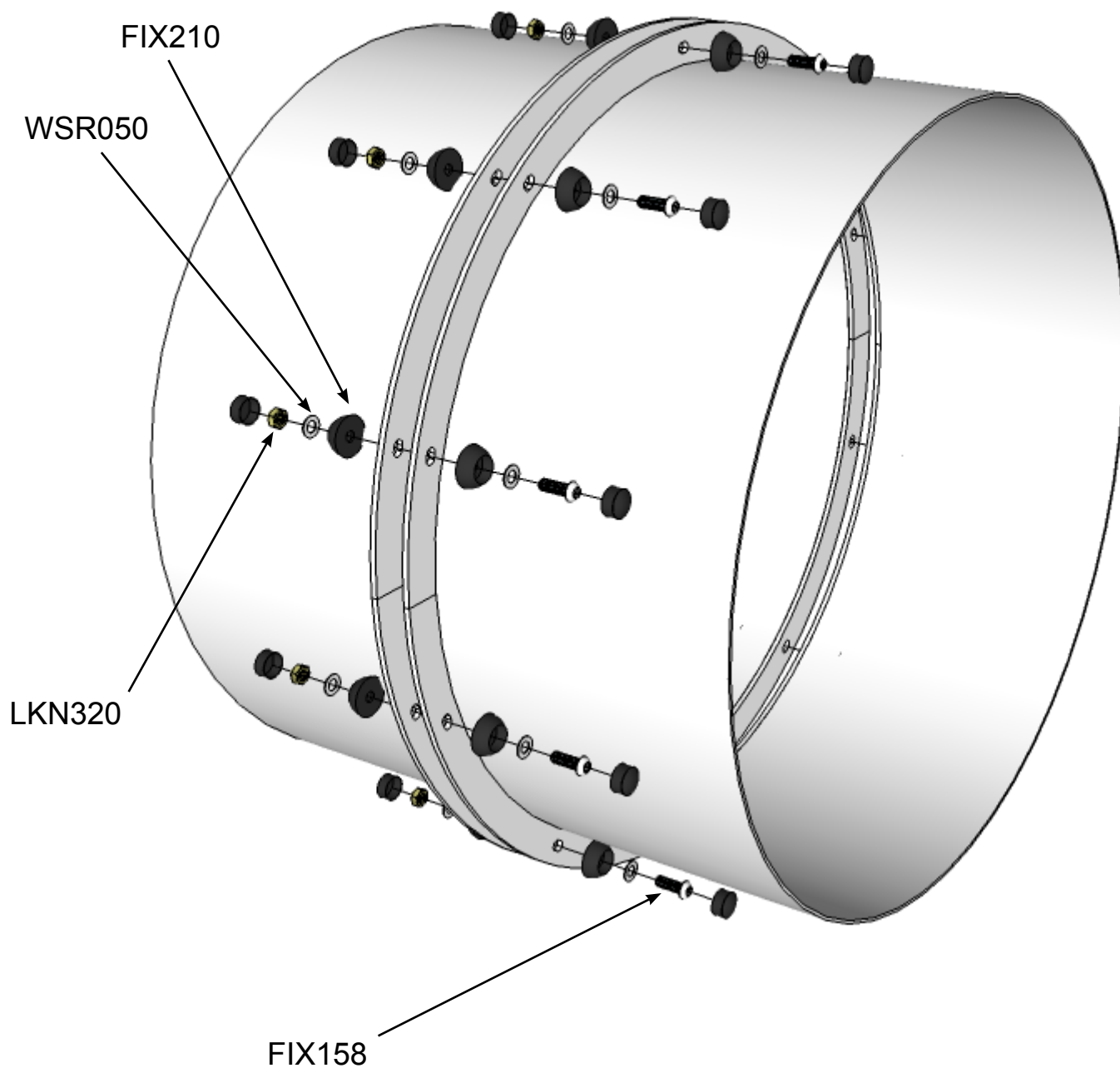

Code	Description	Qty
FIX158	M10 x 35 ST/ST Security Screw	10
LKN320	M10 Nylock Nut	10
FIX210	2 Part Nut Cover	20
WSR050	Plain Washer	20

PZU918J

Jungle Tower

design
make
play

SutcliffePlay

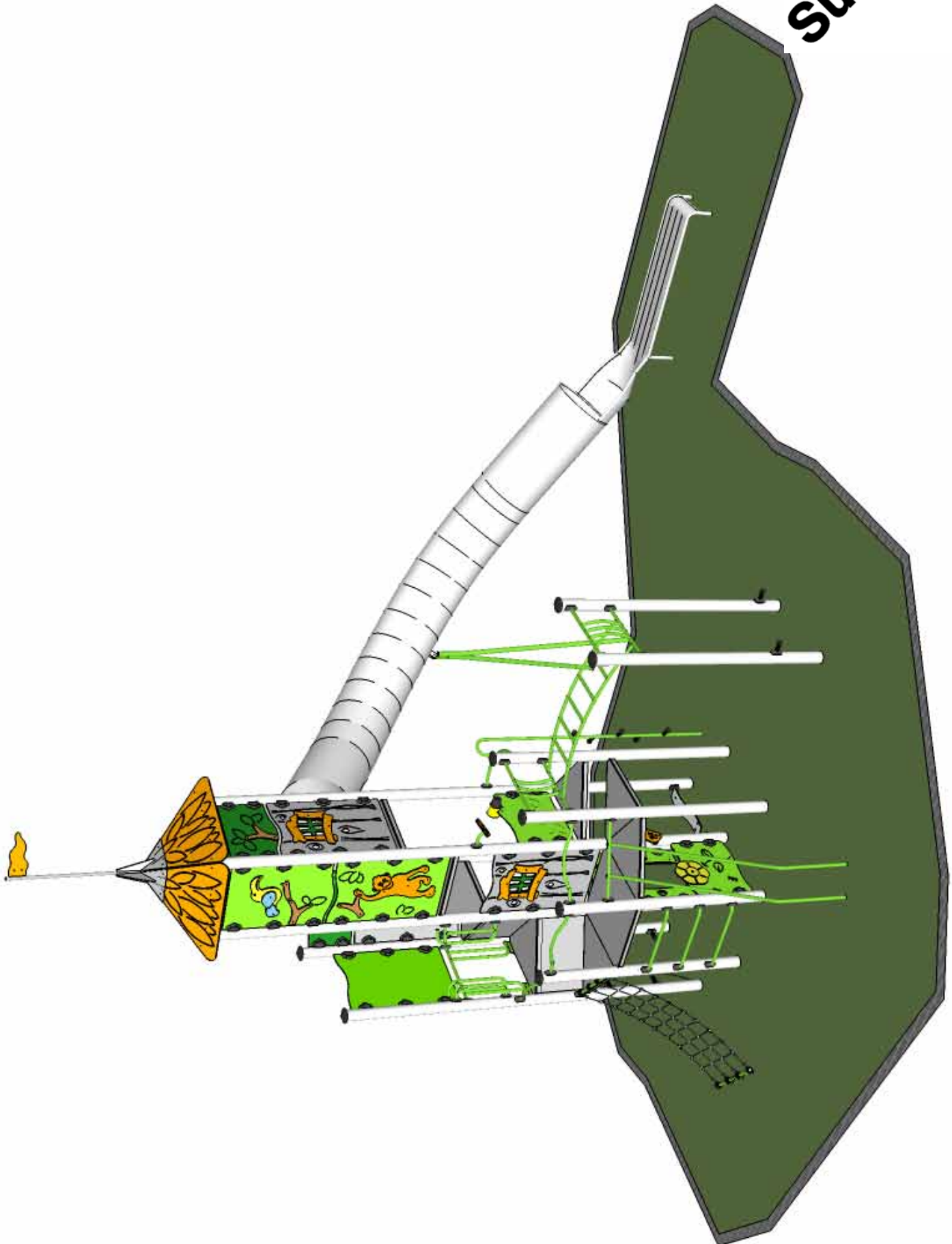

PZU918J

Jungle Tower

design
make
play

SutcliffePlay

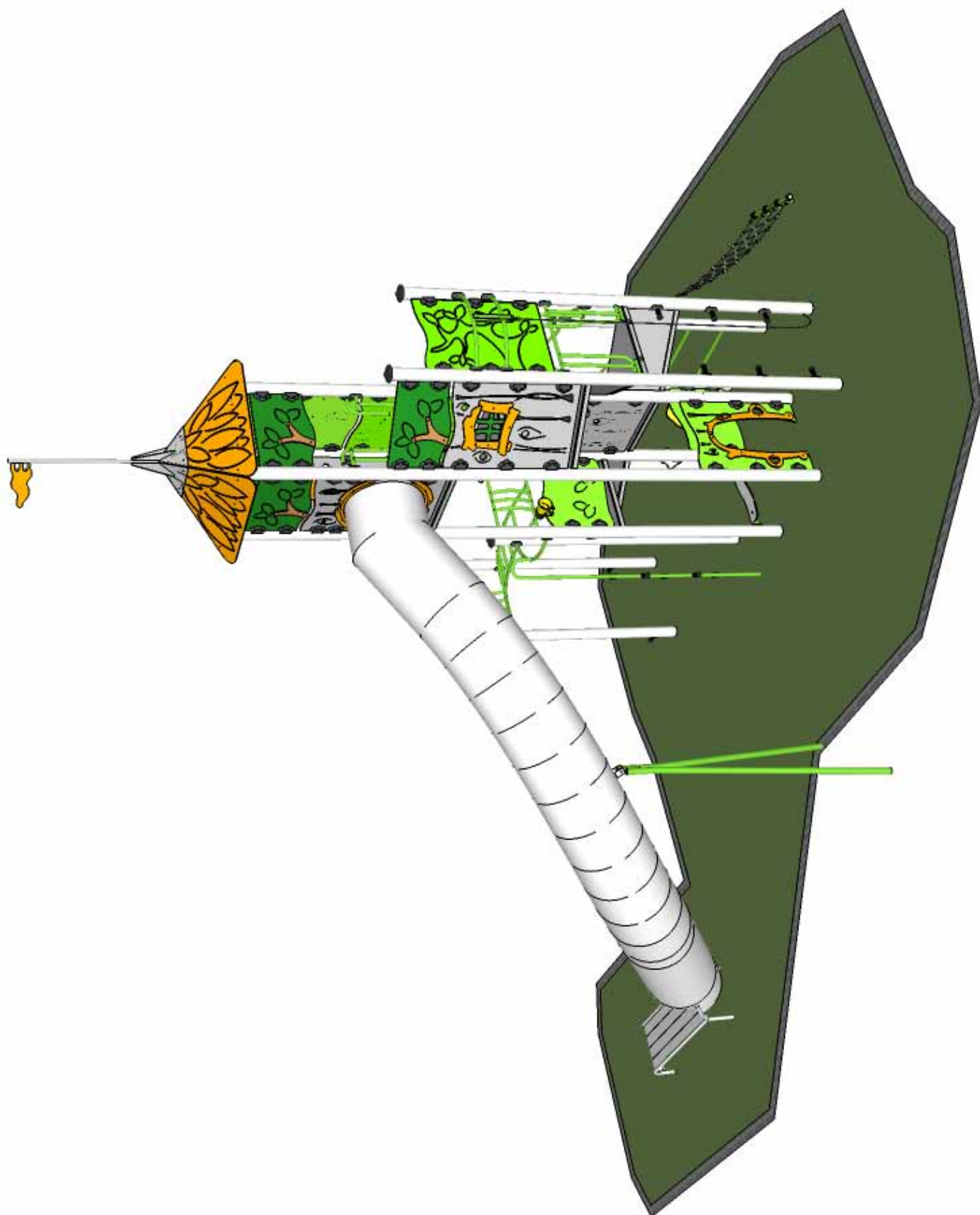

PZU918J

Jungle Tower

design
make
play
SutcliffePlay

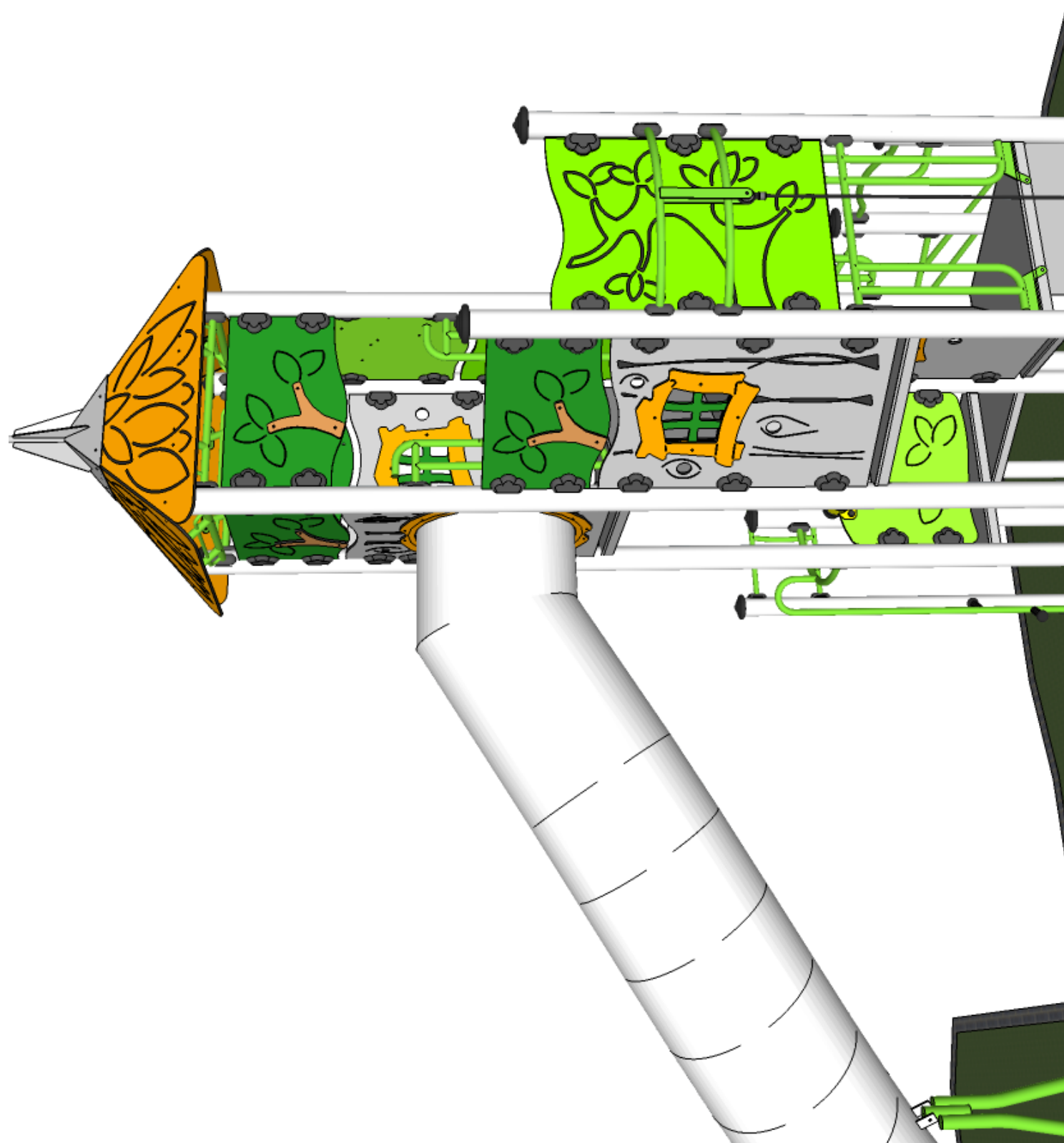

PZU918J

Jungle Tower

design
make
play
SutcliffePlay

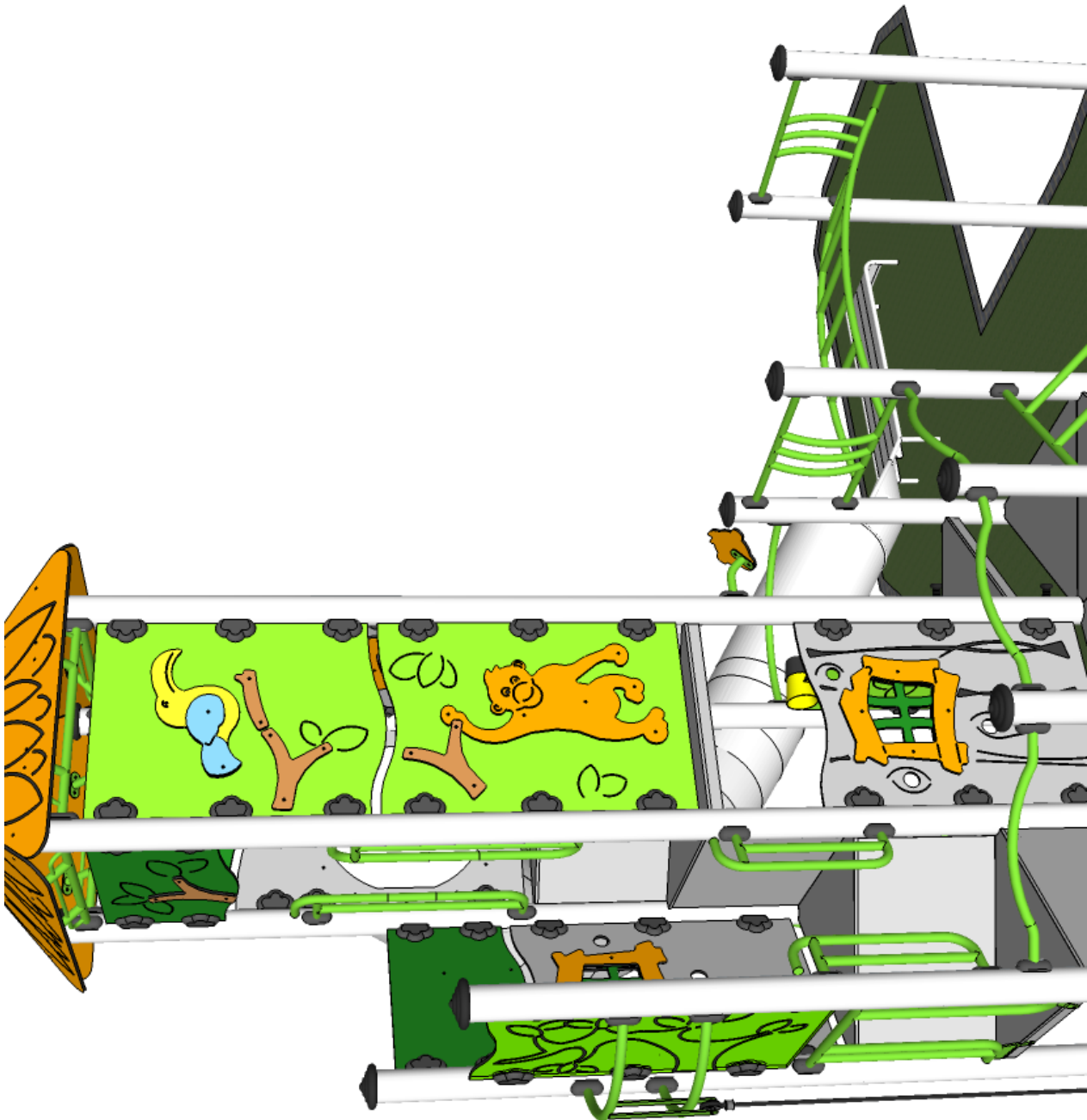

PZU918J

Jungle Tower

design
make
play
SutcliffePlay

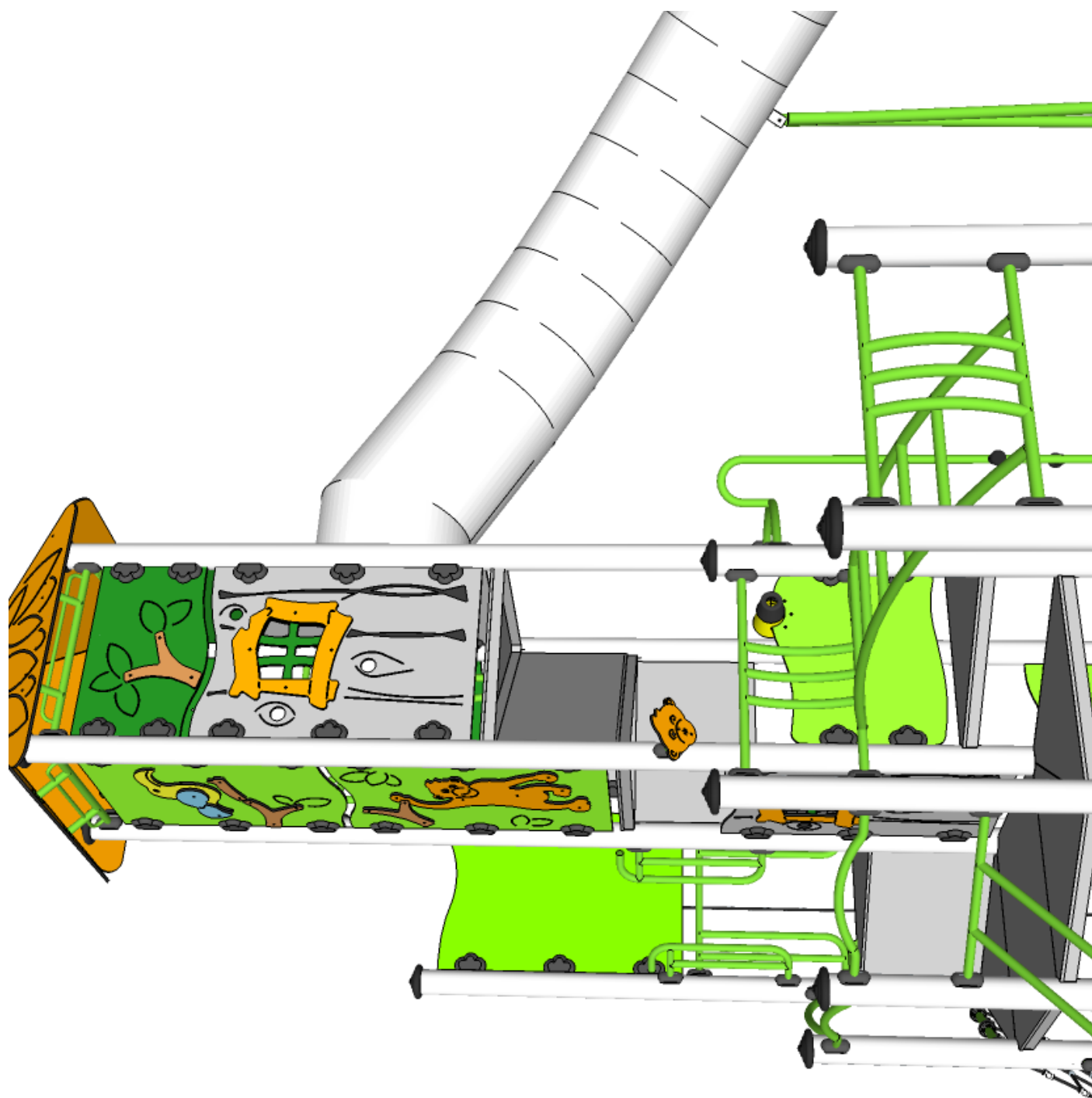

PZU918J

Jungle Tower Maintenance Instructions

design
make
play
SutcliffePlay

NOTE

The warranty is invalidated if these instructions are not followed.
All wood needs annual inspection and retreatment where required.

Recommended Regular Inspection and Maintenance

	Interval Days				
	7	14	28	56	365
Check stability of structure, tighten connections if required.	<input type="checkbox"/>	<input type="checkbox"/>	<input type="checkbox"/>	<input checked="" type="checkbox"/>	<input type="checkbox"/>
Check all uprights at ground level for corrosion and/or rot. Replace any defective parts.	<input type="checkbox"/>	<input type="checkbox"/>	<input type="checkbox"/>	<input type="checkbox"/>	<input checked="" type="checkbox"/>
Check all painted elements for damage, rub down and repaint or replace as required.	<input type="checkbox"/>	<input type="checkbox"/>	<input type="checkbox"/>	<input checked="" type="checkbox"/>	<input type="checkbox"/>
Check chain/ropework assemblies for wear and damage, replace if required.	<input type="checkbox"/>	<input checked="" type="checkbox"/>	<input type="checkbox"/>	<input type="checkbox"/>	<input type="checkbox"/>
Check rotating and pivot points for wear and smooth running lubricate or replace if required.	<input type="checkbox"/>	<input type="checkbox"/>	<input checked="" type="checkbox"/>	<input type="checkbox"/>	<input type="checkbox"/>
Check rubber parts for wear and/or damage, replace if required.	<input type="checkbox"/>	<input type="checkbox"/>	<input checked="" type="checkbox"/>	<input type="checkbox"/>	<input type="checkbox"/>
Check tension cables, adjust if required.	<input type="checkbox"/>	<input type="checkbox"/>	<input checked="" type="checkbox"/>	<input type="checkbox"/>	<input type="checkbox"/>
Check wear of cables, replace if required.	<input type="checkbox"/>	<input type="checkbox"/>	<input checked="" type="checkbox"/>	<input type="checkbox"/>	<input type="checkbox"/>
Check slide chutes for smoothness and any foreign elements, remove any found.	<input type="checkbox"/>	<input type="checkbox"/>	<input checked="" type="checkbox"/>	<input type="checkbox"/>	<input type="checkbox"/>
Check rubber safety surfaces for damage and poor performance, repair or replace if required.	<input type="checkbox"/>	<input type="checkbox"/>	<input type="checkbox"/>	<input checked="" type="checkbox"/>	<input type="checkbox"/>
Check loose fill safety surfaces, remove any foreign elements, rake level and top up if required.	<input type="checkbox"/>	<input type="checkbox"/>	<input checked="" type="checkbox"/>	<input type="checkbox"/>	<input type="checkbox"/>

Disposal Instructions

All components should be broken down into categories of:-

- 1 **Mild Steel** - all Swing Frames, Playzone, Toddlerzone, Teenzone activities, Deck Frames and Springie Frames.
- 2 **Stainless Steel** - all Slides, Mirror Panels.
- 3 **Aluminium** - all Playzone and Toddlerzone Posts.
- 4 **Galvanised Steel** - all Chains and Teenzone Posts.
- 5 **Moulded Rubber Products without steel inserts** - all Toddlerzone Caps and edge details.
- 6 **Timber** - all natural timber, plywood, and MDF panels.

Wherever possible these materials should be taken to specialist recycling organisations and recycled.

In some cases where composite materials are used, then disposal at land fill sites is the only alternative such as:

- 7 **Moulded Rubber Products encasing steel inserts** - all Swing Seats, Deck Tops, Duo/Dizzy Disc Tops.
- 8 **High Pressure Laminate** - all Toddlerzone, Playzone and Teenzone Panels.
- 9 **Steel Core Polypropylene Rope** - all Scramble Nets, Space Nets, Playzone/Toddlerzone Ropes.