

design
make
play

SutcliffePlay

Waggon Lane
Upton Pontefract
West Yorkshire WF9 1JS
Telephone +44 (0) 1977 653200
Facsimile +44 (0) 1977 653222
info@sutcliffeplay.co.uk
www.sutcliffeplay.co.uk

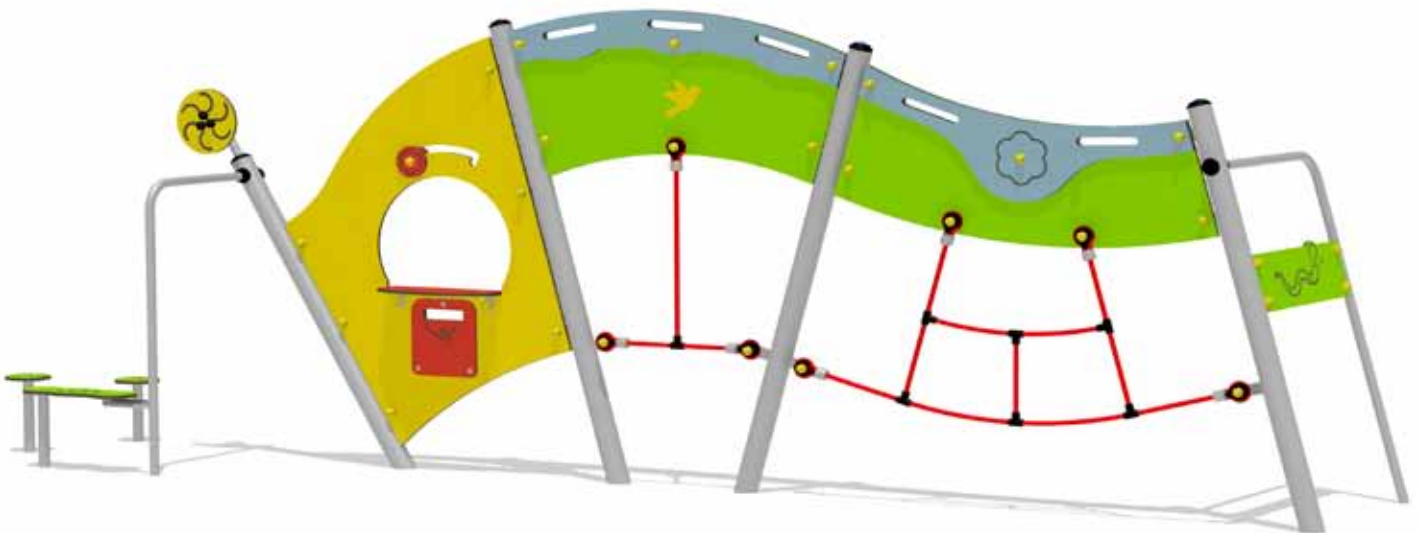

Mini Town Hop & Shop MTU023

(loose fill / wet pour)

Installation Instructions

MTU023

Mini Town Hop & Shop Installation Instruction

1. Check using the parts list that all components have been delivered.
2. Plan the final position of the play equipment, ensuring there is sufficient space.
NB: Please consider the extent and HIC of surfacing (see ground plan).
Although this unit does not require safety surfacing when installed in to grass, no hard edges are permitted within the minimum use zone indicated on the plan.
3. Excavate the foundation holes in accordance with the plan and play level, ensuring the intended safety surface area is level. If you are installing on to any significant gradient, please seek the advice of Sutcliffe Play prior to installation.

NB: DO NOT TIGHTEN FIXINGS UNTIL THE WHOLE UNIT IS ASSEMBLED.

4. Offer the posts into foundation holes, assembling the interconnecting play panels onto them to ensure they are set at the correct dimensions. Please check play level lines on posts are set to the finished play level.
5. Assemble the end bracing legs / activities and the free standing steps in accordance with the ground plan.
6. When all the parts are assembled, tighten all fixings and ensure open rubber caps are filled with blue plugs, use superglue provided to secure in place.
7. Pour concrete into foundation holes as in indicated by the ground plan.
Concrete should be allowed to set fully before being opened for use.

During installation, care must be taken to prevent hazards to children. If you are at all unsure or have any questions, please contact the contracts department immediately for their assistance and advice.

MTU023

Mini Town Hop & Shop Parts List

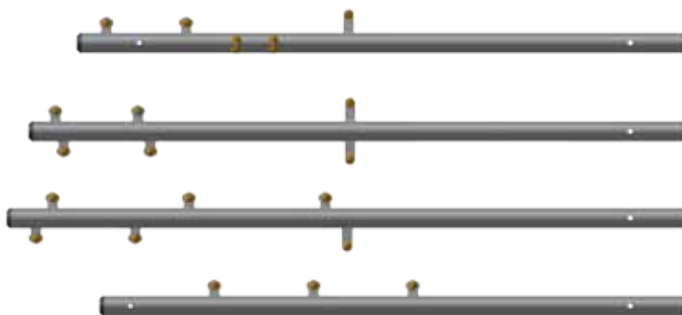

Posts x 4
800014 x 1, 800015 x 1,
800016 x 1, 800017 x 1

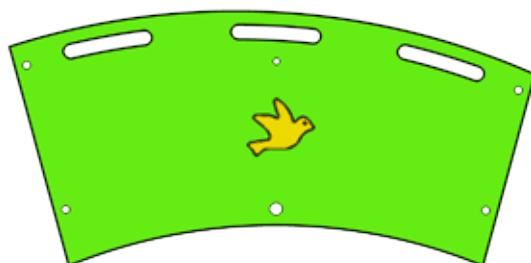

3 Handle Bird
Panel MPA067 x 1



Letter Box Panel
MPP001 x 1



Flower Panel
MPP030R x 2

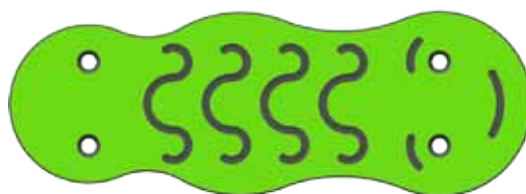

Small Wiggler Panel
MPP026 x 1



Spinner
MTA023 x 1



Bug Face Panel
MPP068 x 2



Counter Panel
MPP069 x 1

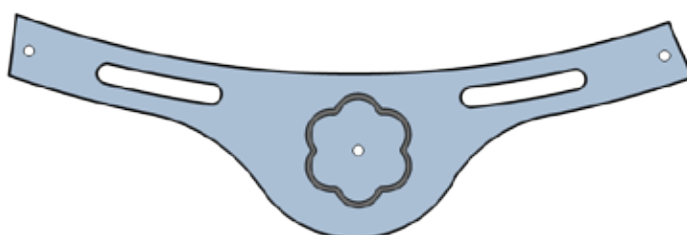

2 Handle Flower Panel
MPP064 x 1

MTU023

Mini Town Hop & Shop Parts List



3 Handle Panel
MPP065 x 1

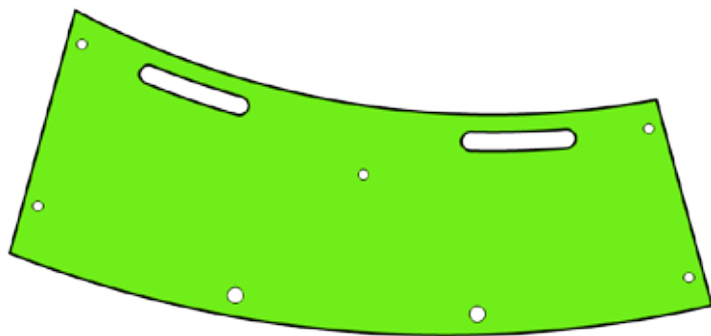

2 Handle Panel
MPP066 x 1

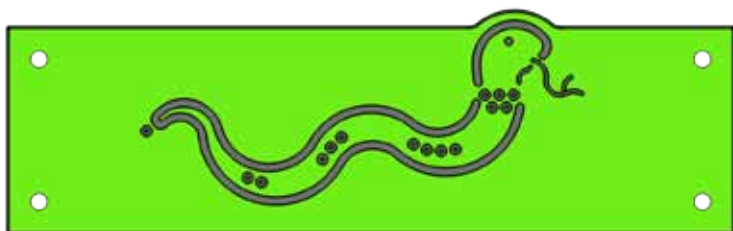

Snake Panel
MPP070 x 1

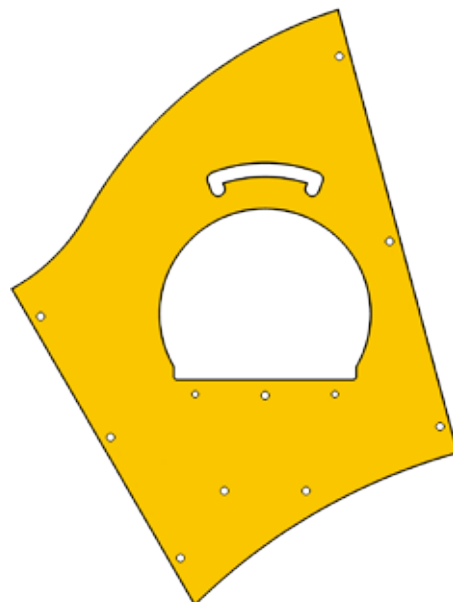

Open Shop Panel
MPP071 x 1

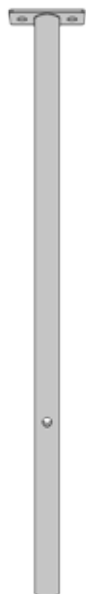

Ground Anchor
PED004GRY x 3

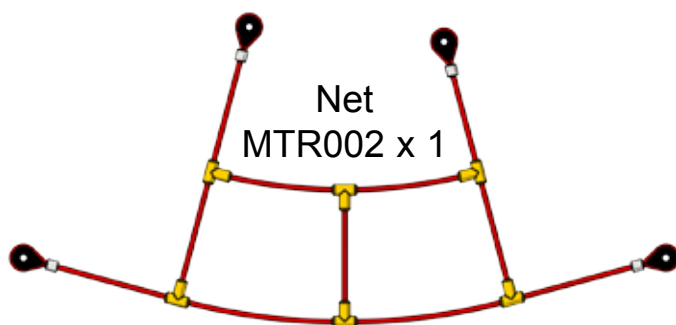

Net
MTR002 x 1

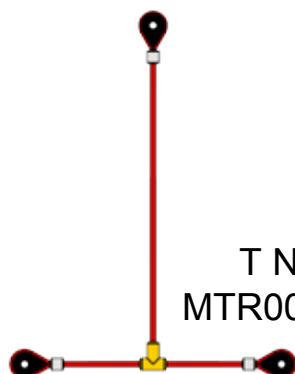

T Net
MTR001 x 1



Fixing Kit
MTU023F x 1

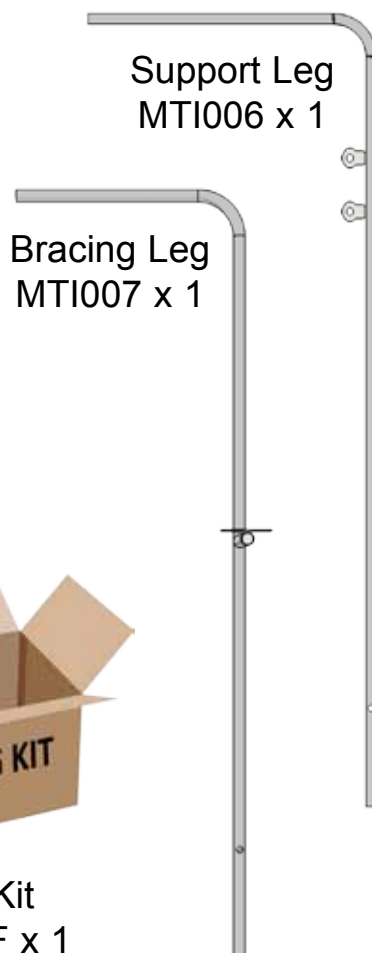

Support Leg
MTI006 x 1

Bracing Leg
MTI007 x 1

MTU023

Mini Town Hop & Shop Panel Fixings

design
make
play

SutcliffePlay

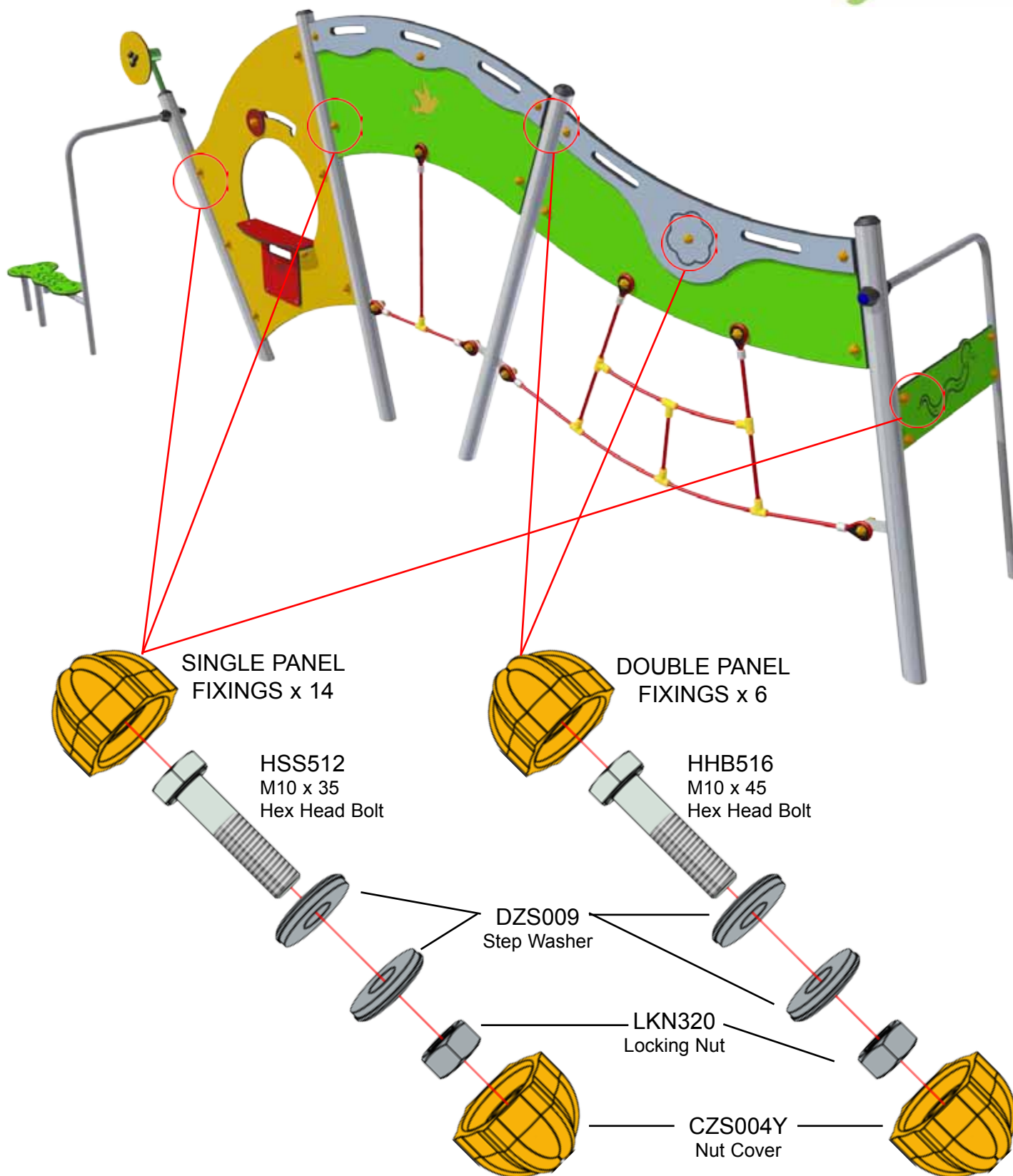

MTU023

Mini Town Hop & Shop Parts Assembly

design
make
play

SutcliffePlay

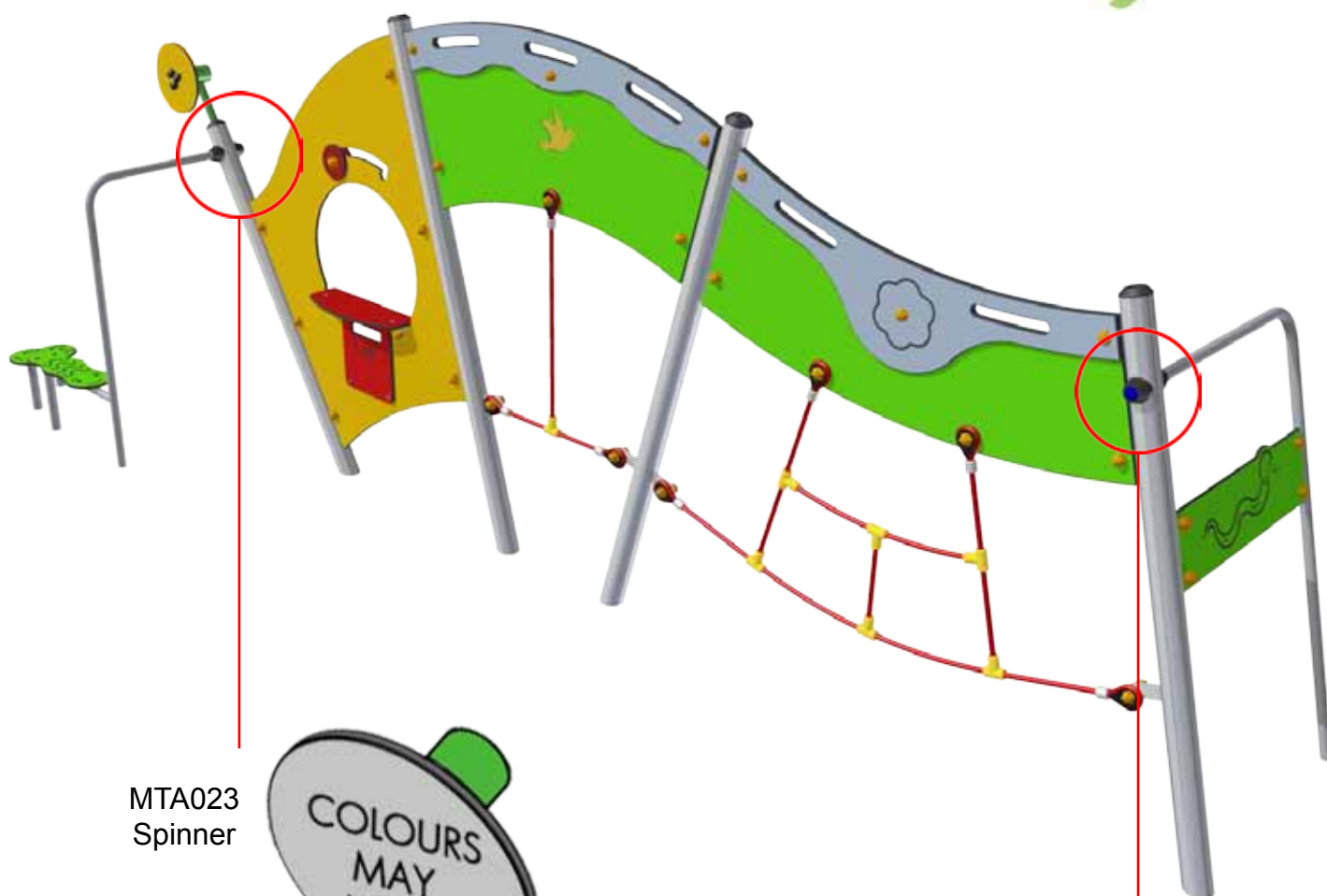

MTA023
Spinner



WSR045

HHB542
M10 x 110
Hex Head Bolt

XZS013B



WSR045

HHB542
M10 x 110
Hex Head Bolt

XZS013B

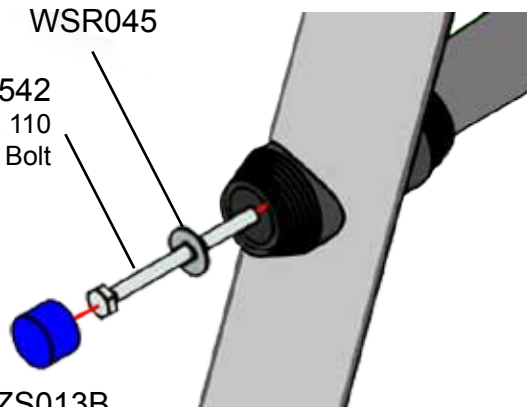

PLEASE NOTE:
SOME ASSEMBLIES ARE ILLIUSTATED IN GENERIC
ORIENTATIONS. PLEASE REFER TO MAIN IMAGES
AND GROUND PLANS FOR THIS PARTICULAR UNIT.

MTU023

Mini Town Hop & Shop Net Fixings

design
make
play

SutcliffePlay

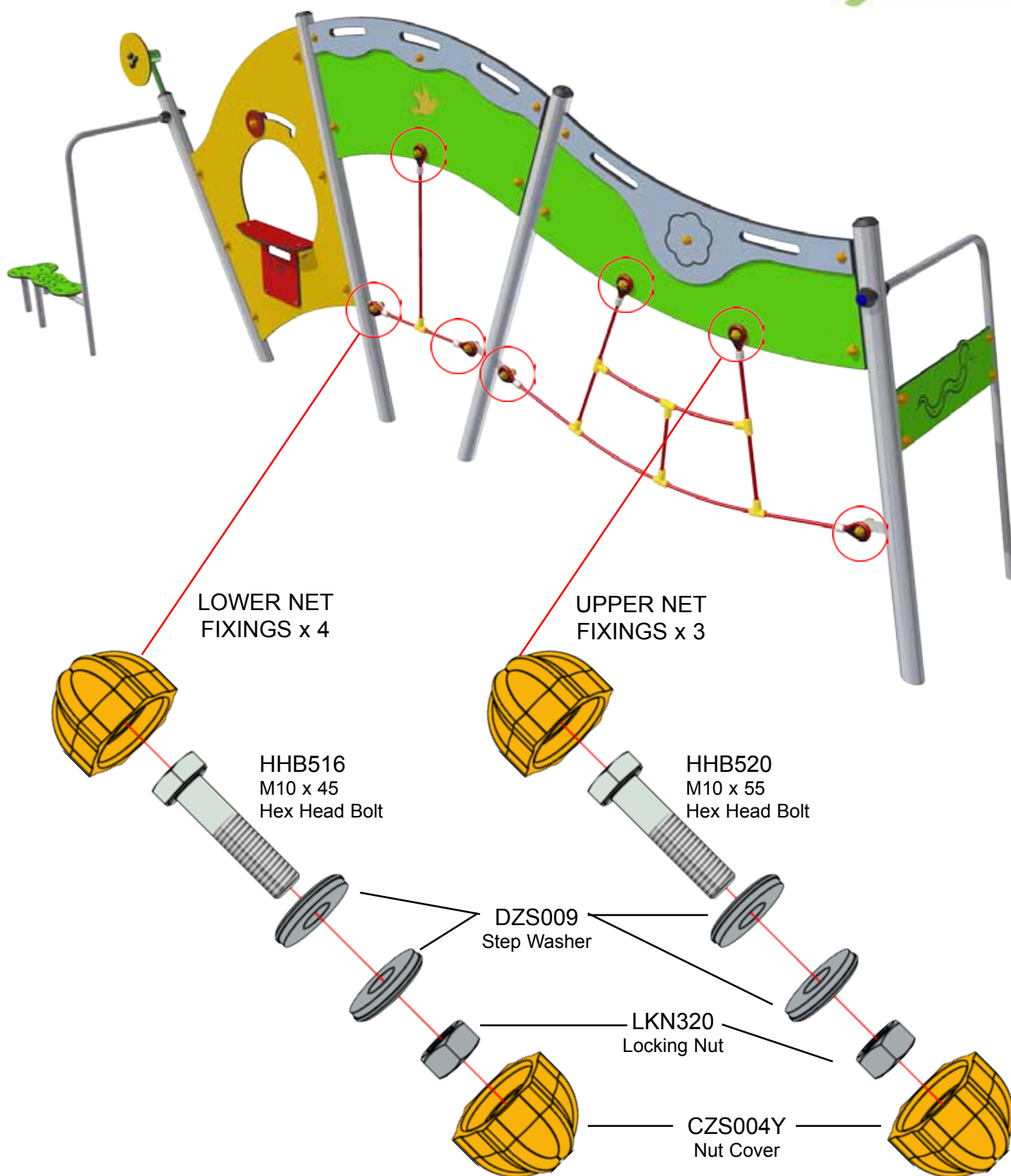

MTU023

Mini Town Hop & Shop Panel Fixings

design
make
play
SutcliffePlay

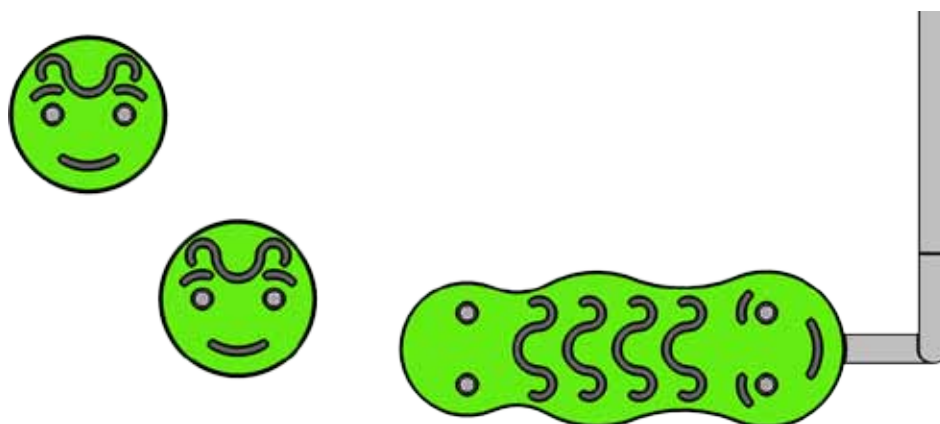

CZS004Y
Nut Cover

LKN320
Lock Nut

DZS009
Step Washer

MCS326
M10 x 40
Countersink Bolt

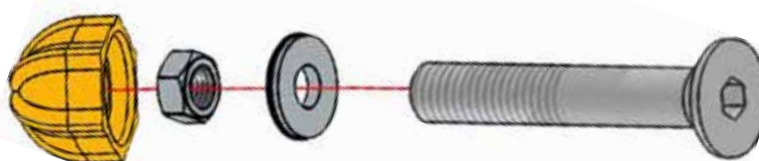

MTU023

Mini Town Hop & Shop Panel Assembly

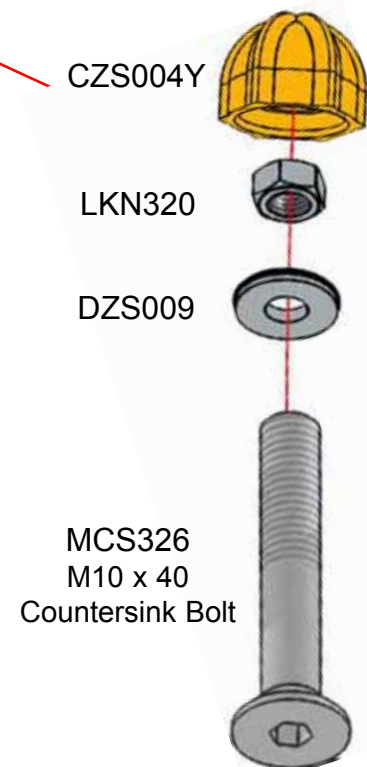
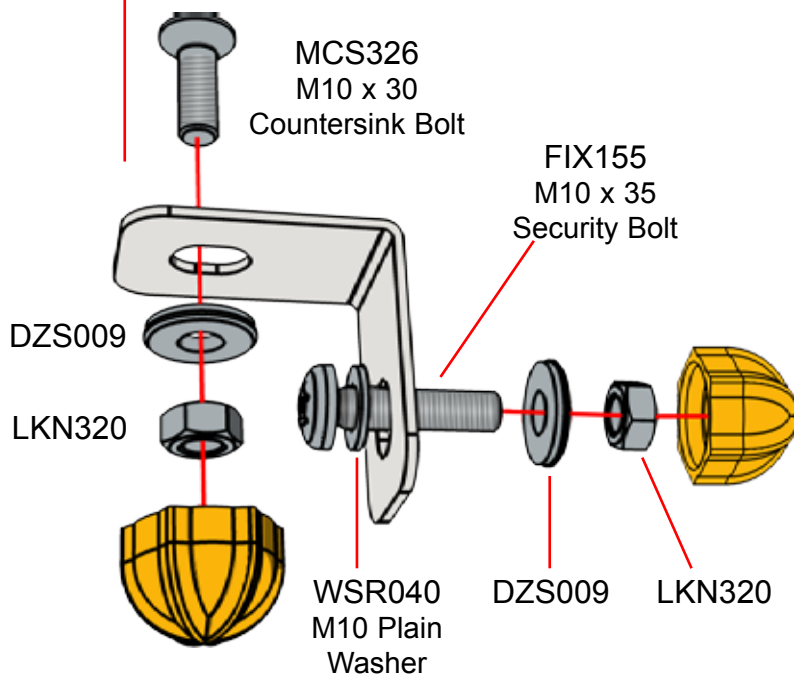
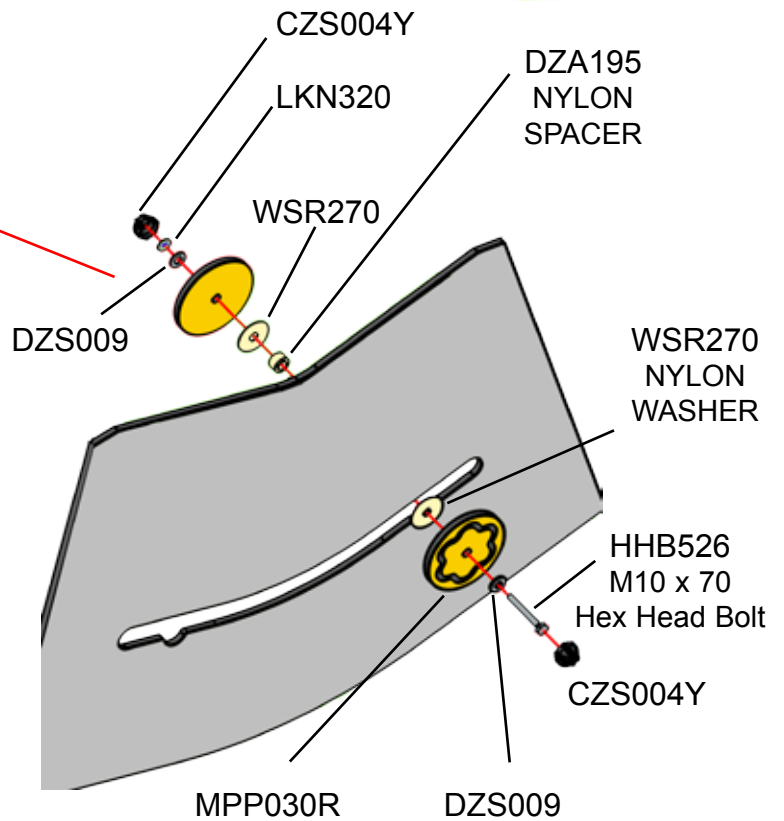
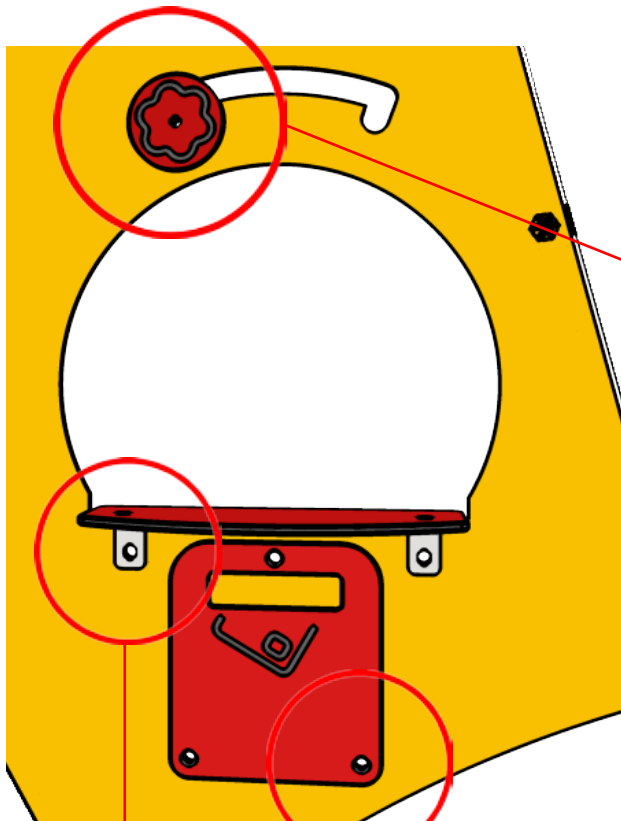

MTU023

Mini Town Hop & Shop Maintenance Instructions

NB: The warranty is invalidated if these instructions are not followed.
All wood needs annual inspection and retreatment where required.

Recommended Regular Inspection and Maintenance

	Interval Days				
	7	14	28	56	365
Check stability of structure, tighten connections if required.	<input type="checkbox"/>	<input type="checkbox"/>	<input type="checkbox"/>	<input checked="" type="checkbox"/>	<input type="checkbox"/>
Check rotating and pivot points for wear and smooth running, lubricate or replace if required.	<input type="checkbox"/>	<input type="checkbox"/>	<input type="checkbox"/>	<input checked="" type="checkbox"/>	<input type="checkbox"/>
Check all painted elements for damage, rub down and repaint or replace as required.	<input type="checkbox"/>	<input type="checkbox"/>	<input type="checkbox"/>	<input checked="" type="checkbox"/>	<input type="checkbox"/>
Check loose fill surfaces for foreign objects (1), depth (2), aerate surface (3)	<input checked="" type="checkbox"/> (1)	<input type="checkbox"/>	<input checked="" type="checkbox"/> (3)	<input checked="" type="checkbox"/> (2)	<input type="checkbox"/>
Check step and 'Wiggler' panels for wear and/or damage, replace if required.	<input type="checkbox"/>	<input type="checkbox"/>	<input type="checkbox"/>	<input checked="" type="checkbox"/>	<input type="checkbox"/>
Check Hexaboard edges and countersunk holes re-paint if required	<input type="checkbox"/>	<input type="checkbox"/>	<input type="checkbox"/>	<input checked="" type="checkbox"/>	<input type="checkbox"/>
Check rubber safety surfaces for damage and poor performance, repair or replace if required.	<input type="checkbox"/>	<input type="checkbox"/>	<input checked="" type="checkbox"/>	<input type="checkbox"/>	<input type="checkbox"/>

Disposal Instructions

All components should be broken down into categories of:-

- 1 **Mild Steel** - all 38mm Ø tube, step/ring climbers, welded bar, swing frames, deck frames, springie frames.
- 2 **Stainless Steel** - all slides, mirror panels.
- 3 **Aluminium** - all Playzone, Mission and Toddlerzone posts.
- 4 **Galvanised Steel** - all chains and Teenzone posts.
- 5 **Moulded Rubber Products without steel inserts** - all Mission and Toddlerzone Caps and edge details.
- 6 **Timber** - all natural timber, plywood, and MDF panels
- 7 **Moulded Rubber Products encasing steel inserts** - all Swing Seats, Deck Tops, Duo/Dizzy Disc Tops.
- 8 **High Pressure Laminate** - all Toddlerzone, Playzone, Minizone, Teenzone and Themed panels.
- 9 **Steel Core Polypropylene Rope** - all Scramble Nets, Space Nets, Playzone/Toddlerzone/Mission Ropes.

Wherever possible these materials should be taken to specialist recycling organisations and recycled. Please note 7,8 and 9 are composite materials which will required specific consideration, for example Energy From Waste.
Recycling methods are ever changing and improving. Always check local recycling arrangements before final disposal