

4.0m Twin Active 4000 Installation Instructions

Rubber Safety Surface

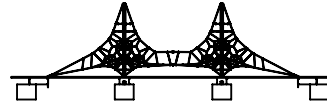

design
make
play
SutcliffePlay

Product Overview

The **Twin Active 4000** Activity Net has been designed to be used by children from 5 years of age and has been manufactured to exceed the European Playground Standard BS-EN 1176-1(2008).

The following installation instructions should be adhered to in order that the equipment functions in a safe manner.

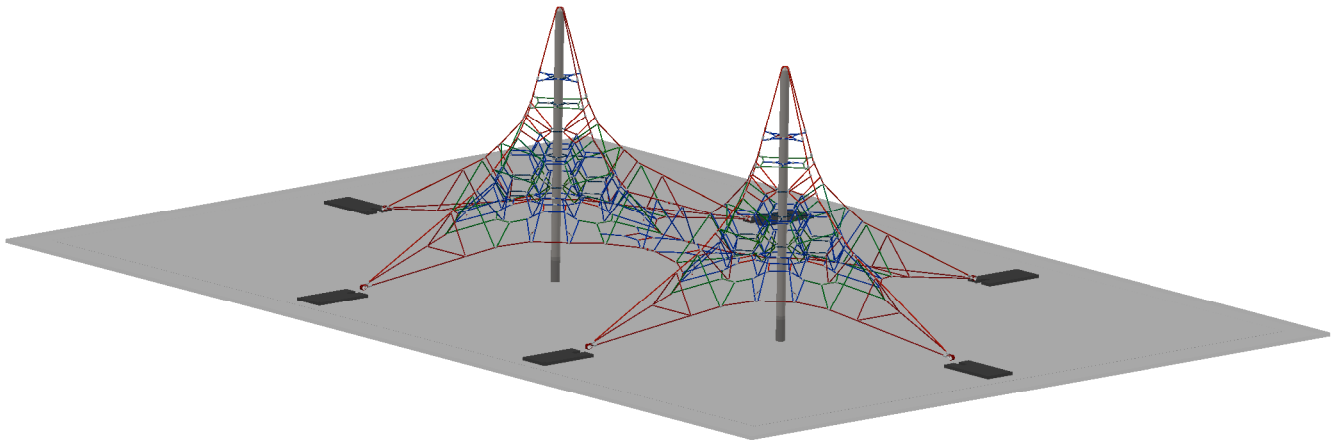

Contents

Space requirements	Page 2
Free height of fall	Page 2
Installation Instructions	Page 2
Foundation Requirements	Page 3
Foundation Setting	Page 4
Excavation & Positioning	Page 5
Assembly Instructions	Page 6
Maintenance & Contact Details	Page 8

Special Points of interest

- Polished stainless steel mast with solid aluminium dome.
- 18mm diameter Nylon braided rope with steel re-enforcement.
- Galvanised foundation steelwork.
- Netform 'HD' aluminium rope connecting system.
- Low Maintenance



- BAUART
GEPRÜFT
- TYPE
APPROVED

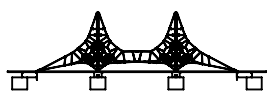

Space requirements & Safety Clearances

The requirements for space and safety clearances are extracted from the following standards BS-EN1176-1

BS-EN1176-1 Section 4.2.8 **Zones**
BS-EN1176-1 Section 4.2.8.2.3 **Free space**

The equipment should be situated to allow 2.0m free space from the edge of the product at ground level. Total area required based on square layout is 201.3m².

Finished assembly showing the recommended safety zones

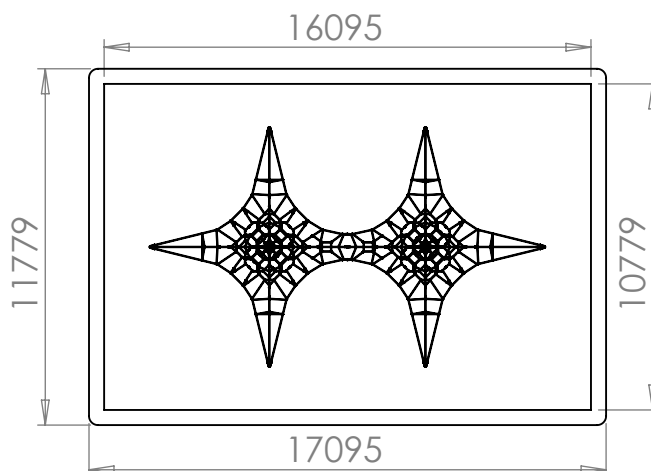

Free Height of fall

The maximum height at which a child can stand, and fall unimpeded is 1066mm, the highest point on the perimeter rope. This is considered to be the free height of fall according to BS-EN 1176 part 11 section 4.3 and therefore a minimum safety surface of 16095x10779 is required.

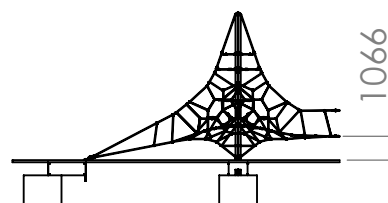

Installation instructions

The **Twin Active 4000** Activity Net is delivered in three sections.

Section One is the polished stainless steel masts which is to be mounted over the central spigots of the foundation steelwork leaving the top of the masts to accept the aluminium domes. This is attached to the top of the net.

Section Two is the two halves of the net, complete with aluminium domes to be inserted into the top of the mast. There are also five shoulder bolts with security bolts for attaching the two halves of the net.

Section Three is the foundation steelwork. This comprises of six galvanised corner anchors, two central galvanised spigot and six safety anchors. The package will also contain six rigging screws for attaching and tensioning the net at each corner to the foundation steelwork.

Section Four is the galvanised corner boxes in flatpack form, with fittings.

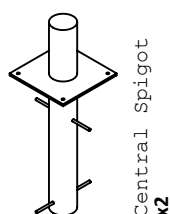
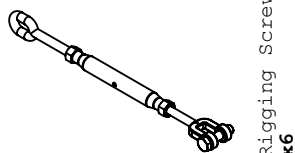
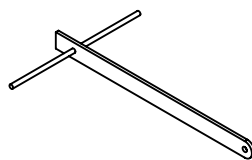
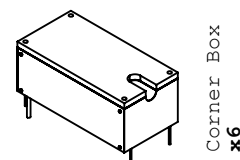
Central Spigot
x2Rigging Screw
x6Safety Anchor
x6Corner Anchor
x6Corner Box
x6

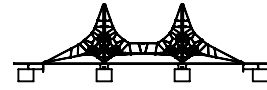

Foundation requirements

General

This net has been designed to allow a rubber safety surface to be used in conjunction with corner boxes. The surface thickness should be based on the CFH of 1066mm. The boxes are supplied with a tile glued to the lid, this ensures the finished ground level is the required 400mm above the concrete.

It is recommended the area is prepared accordingly prior to commencing installation of the net.

Equipment & Tools

The following equipment is recommended to assist in the accurate installation of the foundation anchors.

- 1) Laser Level 2) 20m Measuring Tape 3) JCB Excavator 4) Set Timber
- 5) Manual Tools: Spade, Sledge Hammer, Claw Hammer & Nails

Time Management

Day One:

- 1) Set out the Area 2) Accurately Position and Excavate Holes
- 3) Secure Central & Corner Foundation positions for concreting

Day Two:

- 1) Concrete Steelwork

Day Three*:

- 1) Final erection of Activity Net
- 2) Laying of rubber safety surface material

****The foundation should be left for approximately seven days to achieve maximum strength prior to assembling the remaining elements.***

Foundation Procedure

Setting Out

There are a total of Eight holes that need to be excavated. These include two centre holes (the final position of the central masts) and six holes at each corner (the net will be attached to the subsequently concreted corner anchors by means of rigging screws supplied).

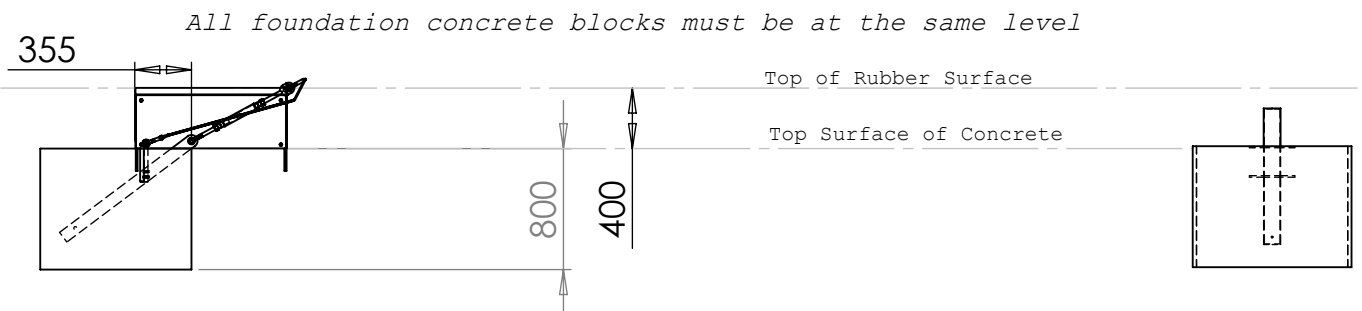

It is important to maintain 400mm between the finished surface level of the safety surface and the top surface level of the concrete. Once the correct position of the holes has been marked prior to excavation, The use of a datum peg is recommended in order to easily relocate the exact foundation position (both horizontally and vertically) which was originally established during setting out.

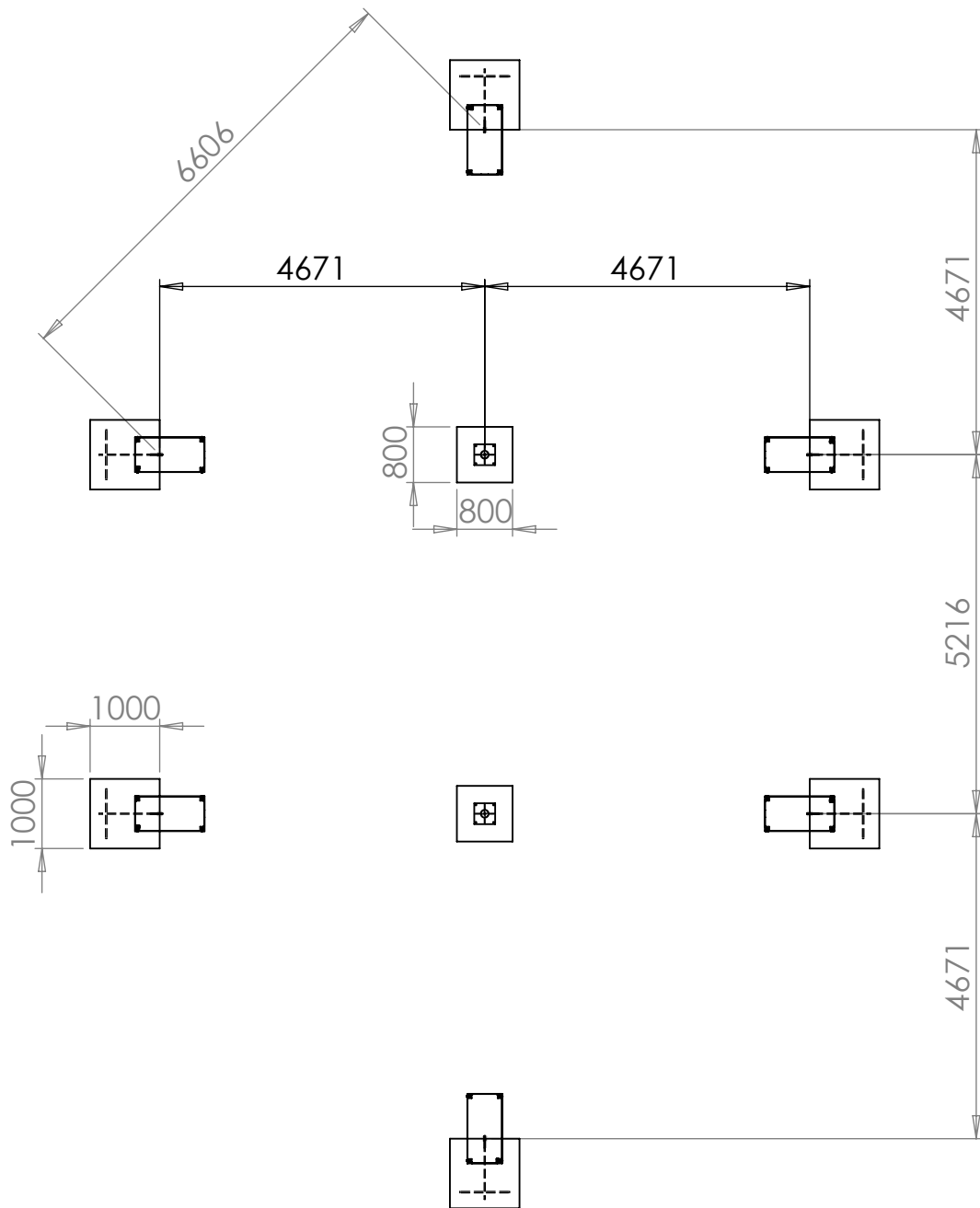
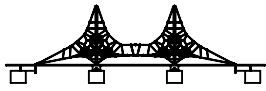

Safety anchor positioned in the hole at the rear of the box.

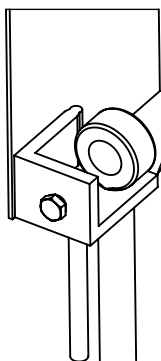

Anchor hole positioned directly above the front of the concrete block.

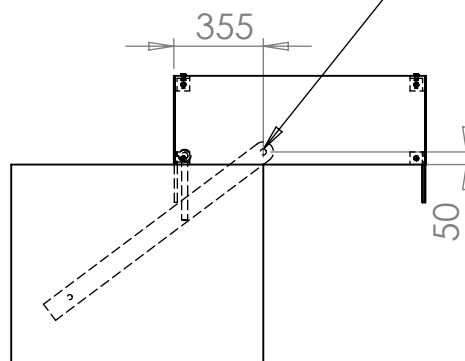

All dimensions to the centre hole in the anchor.

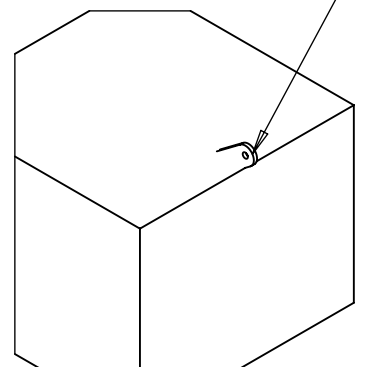

Corner Foundation Hole: 1000x1000x800 **Centre Foundation Hole:** 800x800x800

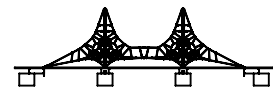

Excavation & Foundation Positioning

Procedure

In loose ground, it may be necessary to use timber framework (or shuttering) to prevent soil falling into the hole. It will also prevent an unnecessary excess volume of concrete being used.

Concrete to be in 30/N mm² mix.
Total volume required: 8.512 cubic metres.

When Installing the four corner anchors, it is extremely important to ensure the eyes of the anchor, and associated safety anchors, are held securely during concreting to minimise any movement.

Install the centre foundation spigot. Use bolted temporary timber supports to suspend and secure the anchor during concreting.

Note:
To easily remove the support timbers following concreting, secure the timbers by bolting from the underside of the spigots top plate.

Datum Peg to Top Hole
Corner Anchor

Shuttering, Pegged and Nailed Timber Frame support anchor and corner box during concreting

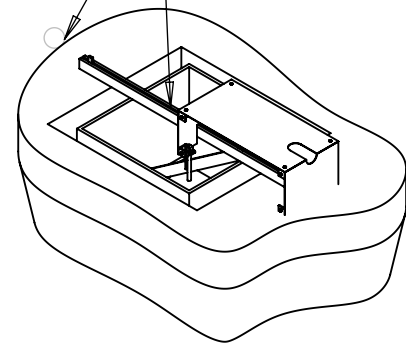

Corner Before Concreting

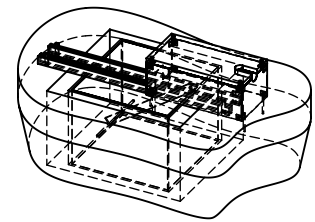
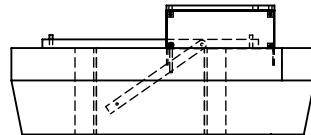

Corner After Concreting

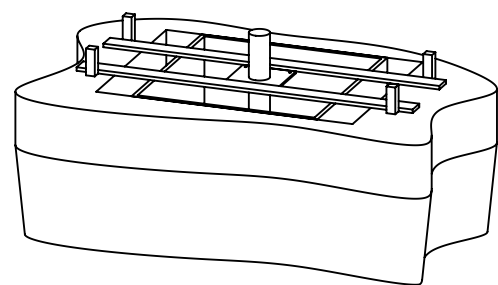

Centre Before Concreting

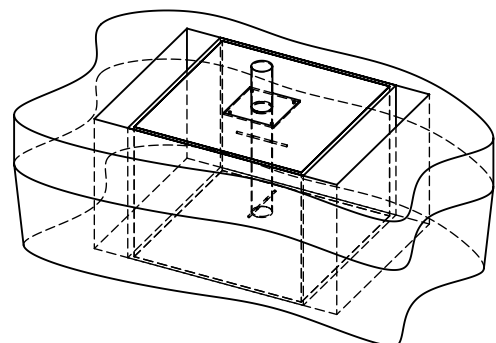

Centre After Concreting

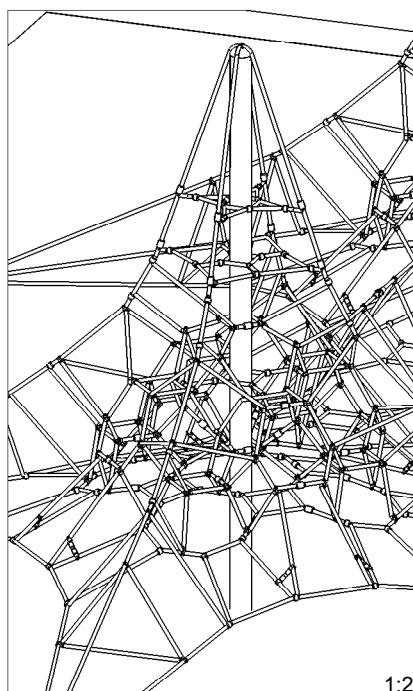
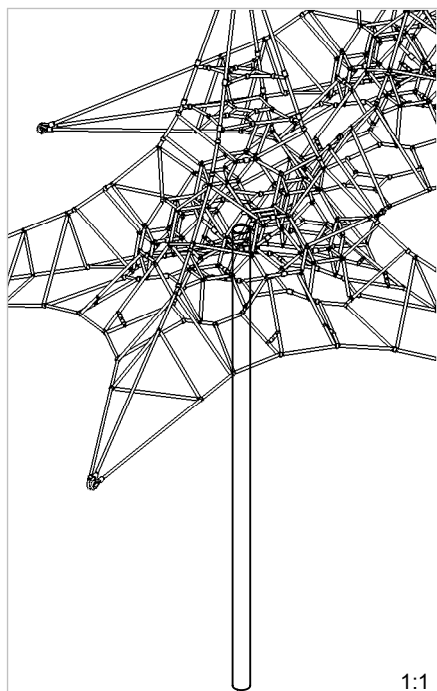
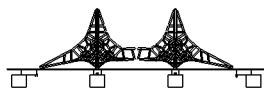

Assembly Instructions

Stage One

Following a seven day curing period, to allow the concrete to gain adequate strength, the final erection of the net can take place.

- 1) Remove Packaging from Net & Mast
- 2) Lay the net out on the ground so all corners are visible
- 3) Thread the mast through the net and locate with aluminium cap into the end of the mast.

Note: Orientation of the mast can be determined from the position of the manufacturers label.

Stage Two

After successfully preparing the net and mast assembly, attach the six rigging screws previously stored, to each of the six corners of the net using the 'greenpin' bow shackles. The bow shackles can be located, already attached, at the net corners.

The rigging screw should be attached so that the 'eye' end is connected to the shackle, leaving the 'jaw' end to attach to the corner anchors.

- 1) To lift the net and mast into their final position, connect a sling (rope or webbing) to the upper part of the mast and lift using the excavating machine.

Note: do not, under any circumstances, allow the lifting of the item using only the net as support as this can cause irreparable damage to the net. The mast must take the support. The certified excavator operator will be able to assist in this operation.

- 2) Locate the base of the mast over the centre spigot. With the excavator still taking the weight, connect the rigging screws to the four corner anchors. Rigging screws should extend to their maximum length at this stage.

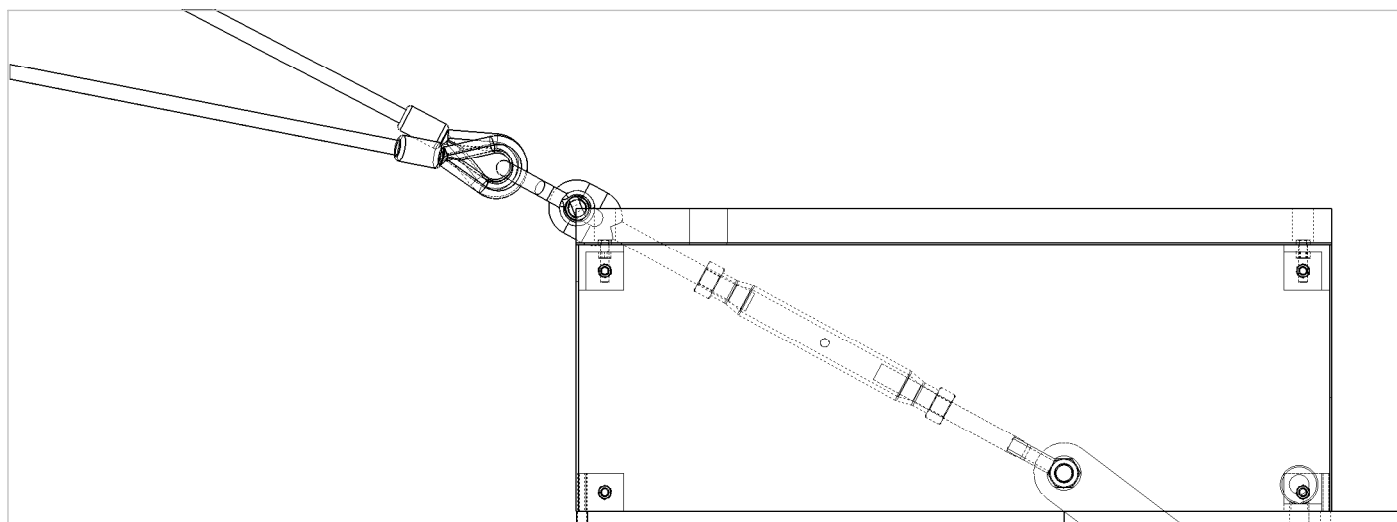

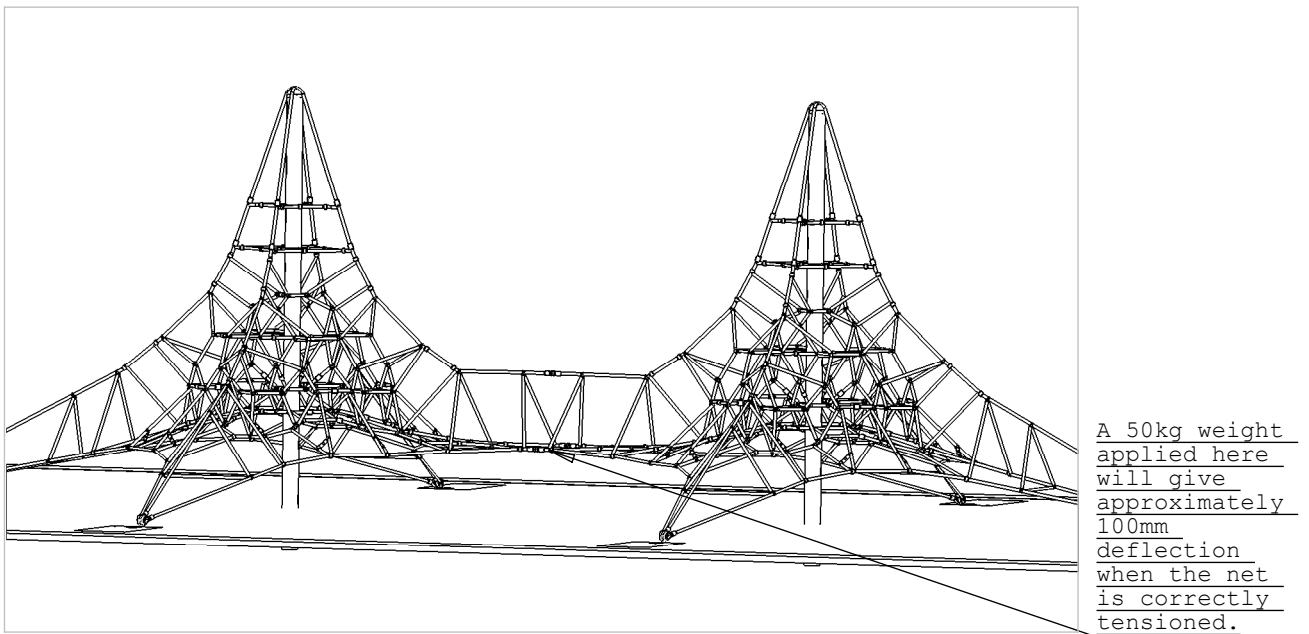
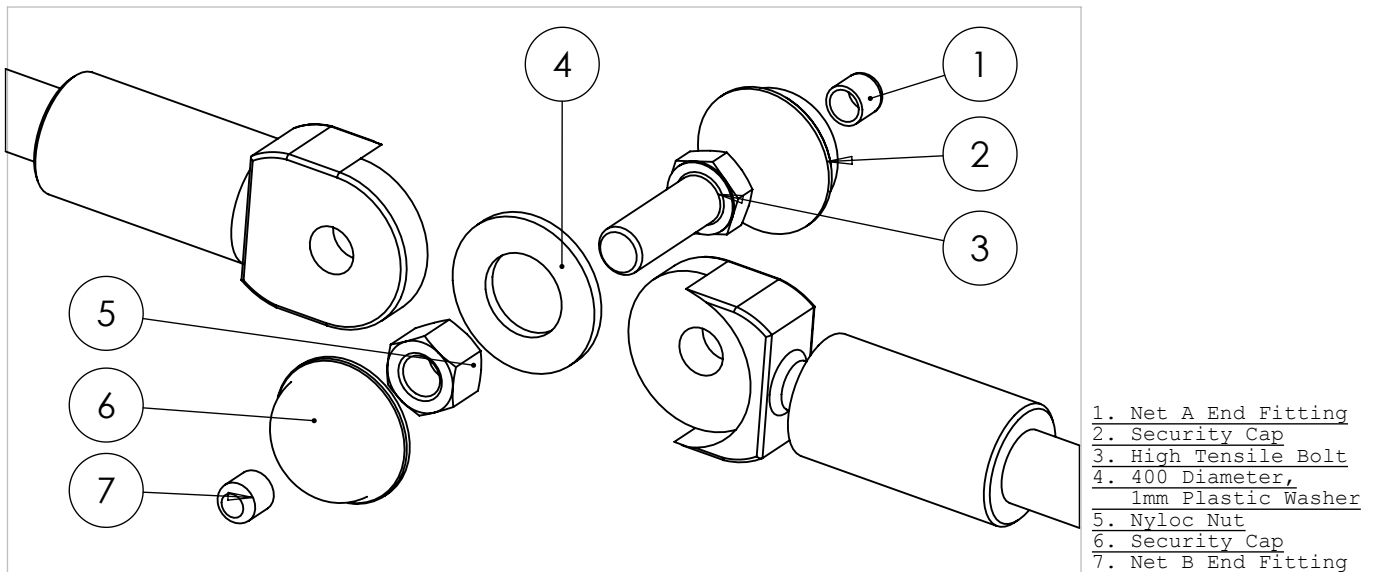
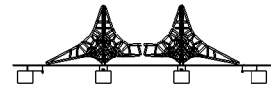

3) Repeat Steps one and two with the second half of the net. Using the shoulder bolts shown, to the top of the page, connect the two halves of the net together. All three turnbuckles should now be tensioned evenly until the masts are vertical.

4) When a 50kg weight is applied to the perimeter rope at the swivel connection this should Deflect approximately 100mm, as shown below, when the net is correctly tensioned. Do not over tighten the net.

5) Connect the second bow shackle on the loop of wire to the safety anchor.

6) Finally secure the corner boxes with their lids using the security bolts supplied.

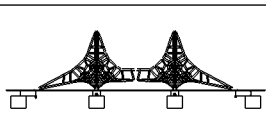

Maintenance & Inspection

General

The **TwinAct4000-R1** activity net should be inspected and maintained in accordance with the recommendations as detailed in BS-EN 1176 part 7: Guidance on installation, inspection, maintenance and operation for playground equipment.

If any part of the equipment is found to be unsafe during an inspection and that part cannot be repaired or replaced immediately, the equipment unit or part(s) concerned should be secured against use. This may involve immobilisation or removal from site.

Important note: The frequency of inspection will vary with the type of equipment or materials used and other factors, e.g. heavy use, levels of vandalism, coastal location, air pollution, age of equipment etc.

Routine Visual Inspection

A routine visual inspection enables the identification of obvious hazards that can result from vandalism, use or weather conditions, e.g. broken parts.

A daily routine visual inspection is recommended especially for playground equipment that has heavy use and/or is subject to vandalism and should include the inspection of the following as a minimum:

1. General equipment and surface cleanliness
2. Equipment ground clearances are maintained
3. Foundations not exposed, loose in the ground or cracked
4. Parts not missing or damaged
5. Surface finishes not damaged, rusting or deteriorating
6. Connections and bolts are secure and tight
7. Bearings are free running
8. Safety surface (if installed) not compacted, damaged or contaminated

Retention the Rope

Periodic checks on tension will help assist in the durability of the product.

After initial tension is complete, the net will stretch approximately 1% over the first two weeks of use. Following this initial period, the net needs to be fully retension by releasing the locking nuts and evenly re-tightening the rigging screws as done in the original installation.

It is recommended that subsequent checks on tension should be carried out at monthly intervals and adjusted as required.

This item is not manufactured by Sutcliffe Play and as such our Sutcliffe Play warranty does not apply. The warranty is as stated by the original manufacturer and subject to following the recommended usage and maintenance guidelines.
