

# Installation instructions

8Ft Swing Frame 4 Seat SSF114

Sheet 1 of 3 Rev 00

design  
make  
play

**SutcliffePlay**

## SSF114 8Ft Swing Frame for 4 Seats

Used on:-

- SWB084** 4 Bumper Seats
- SWC084** 4 Cradle Seats
- SWF084** 4 Flat Seats
- SWP084** 4 Pod Seats

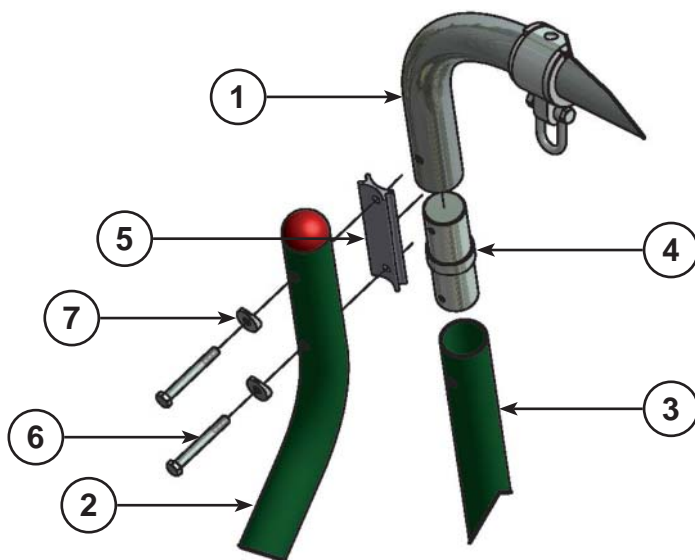
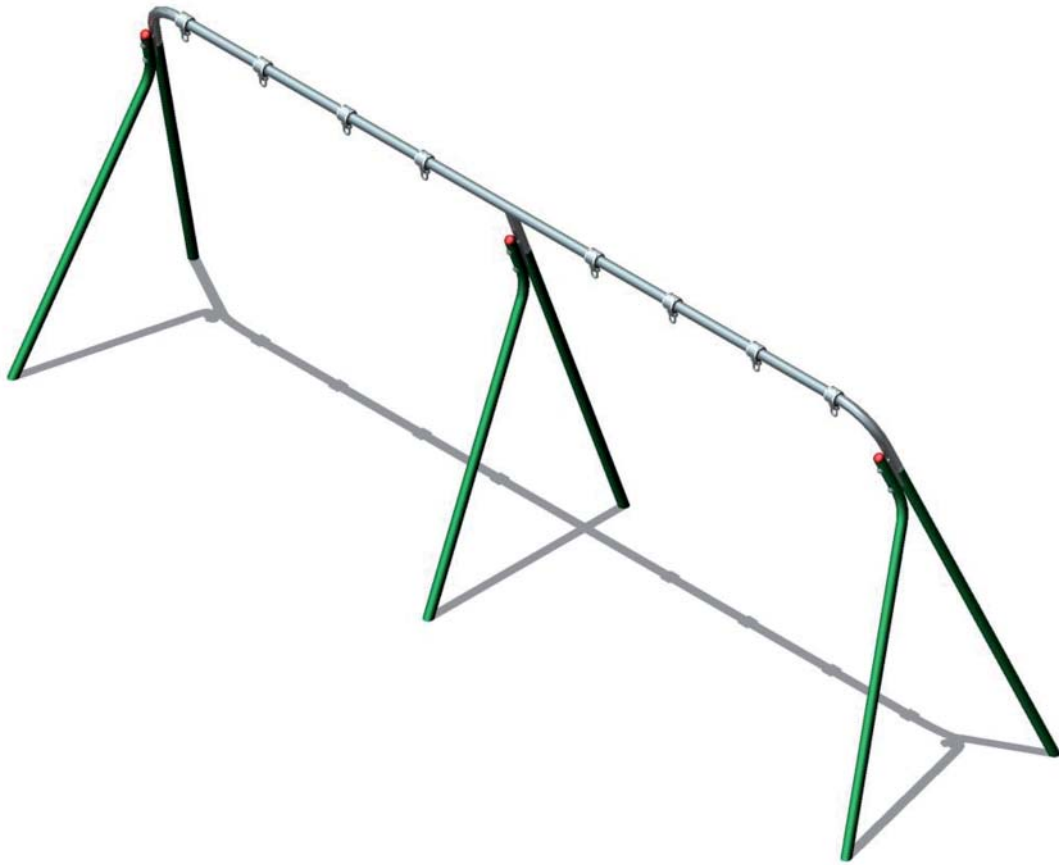

Details for fixing Bent and Straight Legs to the Top Bar

# Installation instructions

8Ft Swing Frame 4 Seat SSF114

Sheet 2 of 3 Rev 00

## Installation procedure

1. Plan the final position of the play equipment ensuring that there is sufficient space\*.
2. Excavate the foundation hole in accordance with the plan\*\*.
3. Assemble the swing frame on the ground. Ensure the fixing bolts are tightened securely.
4. Carefully lift the frame into the foundation holes ensuring it is not twisted. It is important that the top tube is horizontal, use a spirit level to check this.
5. The height from the centre of the top bar to the play level is 2.4M.
6. When the frame is positioned correctly in the foundation holes, fit the spragging irons and fill with concrete. Ensure that the concrete foundations slope away slightly from each leg to prevent water collecting.
7. Do not allow the equipment to be used until the concrete has set (2-3 days) and the required safety surfacing has been installed.
8. Check all the fixing bolts are tightened and hang the required swing seats to the frame.
9. Follow the Maintenance Instructions provided.

\* Care should be taken during installation to decrease the hazard to children.

\*\* Care should be taken if the conditions aren't normal.

## Parts supplied

No	Description	Qty	Stock Code
1	Top Bar 4 Seat	1	STB004GAL
2	8Ft Bent Leg	3	SSW085G02
3	8Ft Straight Leg	3	SSW086G02
4	Joining Bar	3	SSW111
5	Clamp Plate	3	SSW115
6	M12 x 100 Bolts	6	HHB638
7	Saddle Washer	6	WSR436

## Required tools for installation

Tape measure

Spirit level

Step Ladder

Digging equipment

13mm Ring Spanner or Socket

19mm Ring Spanner or Socket

design  
make  
play

**SutcliffePlay**

Waggon Lane  
Upton Pontefract  
West Yorkshire WF9 1JS  
Telephone +44 (0) 1977 653200  
Facsimile +44 (0) 1977 653222  
info@sutcliffeplay.co.uk  
www.sutcliffeplay.co.uk

# Maintenance instructions

8Ft Swing Frame 4 Seat SSF114

Sheet 3 of 3 Rev 00



## NOTE

The warranty is invalidated if these instructions are not followed.

## Recommended regular inspection and maintenance

	Interval days				
	7	14	28	56	365
Check stability of structure, tighten connections if required.	<input type="checkbox"/>	<input type="checkbox"/>	<input type="checkbox"/>	<input checked="" type="checkbox"/>	<input type="checkbox"/>
Check parts at ground level for corrosion and/or rot. Replace any defective parts	<input type="checkbox"/>	<input type="checkbox"/>	<input type="checkbox"/>	<input checked="" type="checkbox"/>	<input type="checkbox"/>
Check all painted elements for damage, rub down and repaint or replace as required.	<input type="checkbox"/>	<input type="checkbox"/>	<input type="checkbox"/>	<input checked="" type="checkbox"/>	<input type="checkbox"/>
Check all ropework assemblies for wear and damage, replace if required.	<input type="checkbox"/>	<input checked="" type="checkbox"/>	<input type="checkbox"/>	<input type="checkbox"/>	<input type="checkbox"/>
Check rotating pivot points for wear and smooth running lubricate or replace if required.	<input type="checkbox"/>	<input checked="" type="checkbox"/>	<input type="checkbox"/>	<input type="checkbox"/>	<input type="checkbox"/>
Check rubber parts for wear and/or damage, replace if required.	<input type="checkbox"/>	<input checked="" type="checkbox"/>	<input type="checkbox"/>	<input type="checkbox"/>	<input type="checkbox"/>
Check rubber safety surfaces for damage and poor performance, repair or replace if required.	<input type="checkbox"/>	<input type="checkbox"/>	<input type="checkbox"/>	<input checked="" type="checkbox"/>	<input type="checkbox"/>
Check loose fill safety surfaces remove any foreign elements, repair or replace if required.	<input type="checkbox"/>	<input checked="" type="checkbox"/>	<input type="checkbox"/>	<input type="checkbox"/>	<input type="checkbox"/>

## Disposal Instructions

All components should be broken down into categories of:-

1. **Mild Steel** - all swing frames, Playzone, Toddlerzone and Teenzone activities, deck frames and springie frames.
2. **Stainless Steel** - all slides, mirror panels.
3. **Aluminium** - all Playzone and Toddlerzone posts.
4. **Galvanised steel** - all chains and Teenzone posts.
5. **Moulded rubber products without steel inserts** - all Toddlerzone and Playzone caps and panel edging.
6. **Timber** - all natural timber, plywood and mdf panels.

Wherever possible these materials should be taken to a specialist recycling organisations and recycled. In some cases where composite materials are used then disposal at land fill sites is the only alternative such as:-

7. **Moulded rubber product with steel inserts** - all seats, deck tops, duo/dizzy disc tops.
8. **High pressure laminate** - all Toddlerzone and Playzone panels.
9. **Steel core polypropylene rope** - all scramble nets, space nets, Playzone and Toddlerzone ropes and rope bridges.