

Installation instructions

6Ft Swing Frame 1 Seat SSF105

Sheet 1 of 3 Rev 00

design
make
play

SutcliffePlay

SSF105 6Ft Swing Frame for 1 Seat

Used on:-

SWB061 1 Bumper Seat

SWC061 1 Cradle Seat

SWF061 1 Flat Seat

SWP061 1 Pod Seat

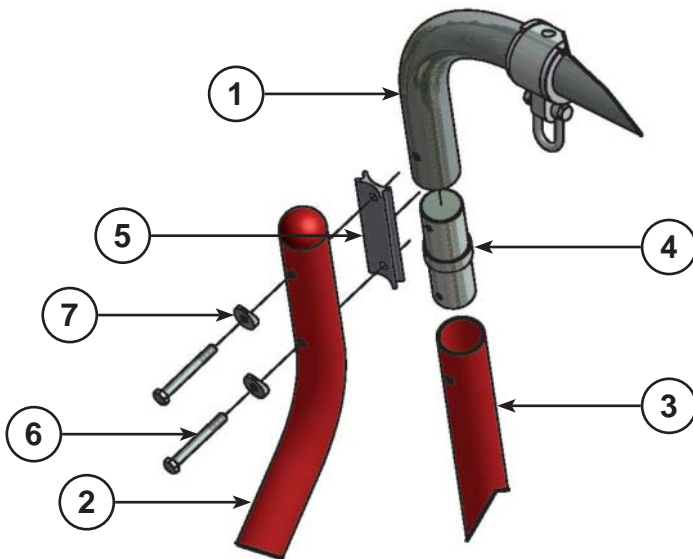

Details for fixing Bent and Straight Legs to the Top Bar

Installation instructions

6Ft Swing Frame 1 Seat SSF105

Sheet 2 of 3 Rev 00

Installation procedure

1. Plan the final position of the play equipment ensuring that there is sufficient space*.
2. Excavate the foundation hole in accordance with the plan**.
3. Assemble the swing frame on the ground. Ensure the fixing bolts are tightened securely.
4. Carefully lift the frame into the foundation holes ensuring it is not twisted. It is important that the top tube is horizontal, use a spirit level to check this.
5. The height from the centre of the top bar to the play level is 1.8M.
6. When the frame is positioned correctly in the foundation holes, fit the spragging irons and fill with concrete. Ensure that the concrete foundations slope away slightly from each leg to prevent water collecting.
7. Do not allow the equipment to be used until the concrete has set (2-3 days) and the required safety surfacing has been installed.
8. Check all the fixing bolts are tightened and hang the required swing seats to the frame.
9. Follow the Maintenance Instructions provided.

* Care should be taken during installation to decrease the hazard to children.

** Care should be taken if the conditions aren't normal.

Parts supplied

No	Description	Qty	Stock Code
1	Top Bar 1 Seat	1	STB001GAL
2	6Ft Bent Leg	2	SSW065R00
3	6Ft Straight Leg	2	SSW066R00
4	Joining Bar	2	SSW111
5	Clamp Plate	2	SSW115
6	M12 x 100 Bolts	4	HHB638
7	Saddle Washer	4	WSR436

Required tools for installation

Tape measure

Spirit level

Step Ladder

Digging equipment

13mm Ring Spanner or Socket

19mm Ring Spanner or Socket

design
make
play

SutcliffePlay

Waggon Lane
Upton Pontefract
West Yorkshire WF9 1JS
Telephone +44 (0) 1977 653200
Facsimile +44 (0) 1977 653222
info@sutcliffeplay.co.uk
www.sutcliffeplay.co.uk

Maintenance instructions

6Ft Swing Frame 1 Seat SSF105

Sheet 3 of 3 Rev 00



NOTE

The warranty is invalidated if these instructions are not followed.

Recommended regular inspection and maintenance

	Interval days				
	7	14	28	56	365
Check stability of structure, tighten connections if required.	<input type="checkbox"/>	<input type="checkbox"/>	<input type="checkbox"/>	<input checked="" type="checkbox"/>	<input type="checkbox"/>
Check parts at ground level for corrosion and/or rot. Replace any defective parts	<input type="checkbox"/>	<input type="checkbox"/>	<input type="checkbox"/>	<input checked="" type="checkbox"/>	<input type="checkbox"/>
Check all painted elements for damage, rub down and repaint or replace as required.	<input type="checkbox"/>	<input type="checkbox"/>	<input type="checkbox"/>	<input checked="" type="checkbox"/>	<input type="checkbox"/>
Check all ropework assemblies for wear and damage, replace if required.	<input type="checkbox"/>	<input checked="" type="checkbox"/>	<input type="checkbox"/>	<input type="checkbox"/>	<input type="checkbox"/>
Check rotating pivot points for wear and smooth running lubricate or replace if required.	<input type="checkbox"/>	<input checked="" type="checkbox"/>	<input type="checkbox"/>	<input type="checkbox"/>	<input type="checkbox"/>
Check rubber parts for wear and/or damage, replace if required.	<input type="checkbox"/>	<input checked="" type="checkbox"/>	<input type="checkbox"/>	<input type="checkbox"/>	<input type="checkbox"/>
Check rubber safety surfaces for damage and poor performance, repair or replace if required.	<input type="checkbox"/>	<input type="checkbox"/>	<input type="checkbox"/>	<input checked="" type="checkbox"/>	<input type="checkbox"/>
Check loose fill safety surfaces remove any foreign elements, repair or replace if required.	<input type="checkbox"/>	<input checked="" type="checkbox"/>	<input type="checkbox"/>	<input type="checkbox"/>	<input type="checkbox"/>

Disposal Instructions

All components should be broken down into categories of:-

1. **Mild Steel** - all swing frames, Playzone, Toddlerzone and Teenzone activities, deck frames and springie frames.
2. **Stainless Steel** - all slides, mirror panels.
3. **Aluminium** - all Playzone and Toddlerzone posts.
4. **Galvanised steel** - all chains and Teenzone posts.
5. **Moulded rubber products without steel inserts** - all Toddlerzone and Playzone caps and panel edging.
6. **Timber** - all natural timber, plywood and mdf panels.

Wherever possible these materials should be taken to a specialist recycling organisations and recycled. In some cases where composite materials are used then disposal at land fill sites is the only alternative such as:-

7. **Moulded rubber product with steel inserts** - all seats, deck tops, duo/dizzy disc tops.
8. **High pressure laminate** - all Toddlerzone and Playzone panels.
9. **Steel core polypropylene rope** - all scramble nets, space nets, Playzone and Toddlerzone ropes and rope bridges.